

O4IDB

Wide Multi-Deck Island Merchandiser
6', 8' & 12' (Deli / Meat) Single Wrap-Around End

GENERAL NOTES

- "---" indicates that the feature is not an option on this case model and/or the data is not yet available.
- LED lights only.

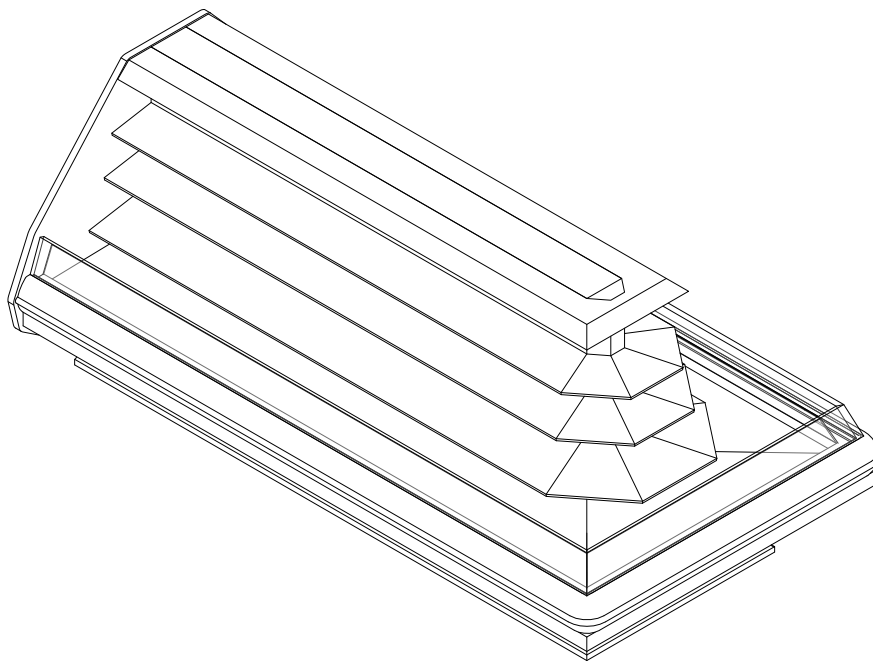

| SHIPPING WEIGHT | |
|-----------------|--------|
| Case | Weight |
| O4IDB | --- |



2017 DOE COMPLIANT COMPONENT
ALL MEASUREMENTS ARE TAKEN PER ASHRAE-72-2005 SPECIFICATIONS. HILLPHOENIX REFRIGERATED DISPLAY CASES FOR SALE IN THE UNITED STATES MEET OR EXCEED DEPARTMENT OF ENERGY 2017 REQUIREMENTS.

O4IDB

| Rev Date: | Rev # | Revision Description: |
|-----------|-------|-----------------------|
| 7-25-18 | 2 | NEW STANDARDS |
| 12-1-17 | 1 | DOE 2017 |

Hillphoenix
A DOWDY COMPANY

| ELECTRICAL DATA | | | | | | | | | |
|-----------------|---------------|----------------------|-------|-------------------------|-------|-----------------------------------|-------|----------------------|-------|
| Case Length | Fans Per Case | High Efficiency Fans | | Anti Condensate Heaters | | Defrost Heaters | | | |
| | | 120 Volts | | 120 Volts | | Standard Power (Cornice or Shelf) | | High Power (Cornice) | |
| | | Amps | Watts | Amps | Watts | Amps | Watts | Amps | Watts |
| 6' | 4 | 0.47 | 28.0 | 0.63 | 76.0 | 5.77 | 1200 | 6.66 | 1596 |
| 8' | 6 | 0.70 | 42.0 | 0.88 | 106.0 | 7.70 | 1600 | 8.88 | 2130 |
| 12' | 8 | 0.94 | 56.0 | 1.24 | 149.0 | 11.54 | 2400 | 13.2 | 3200 |

| LIGHTING DATA | | | | | | | | | |
|---------------|-----------------|----------------|-----------------------------|--|-------|------------------|-------|--|--|
| Case End | Shelf Depth | Lights Per Row | Light Length | Clearvoyant LED Lighting (Per Light Row) | | | | | |
| | | | | Standard Power | | High Power Power | | | |
| | | | | Cornice or Shelf | | Cornice Only | | | |
| | | | | 120 Volts | | 120 Volts | | | |
| Amps | Watts | Amps | Watts | Amps | Watts | Amps | Watts | | |
| 6' | Top Sill | 3 | 1 (2ft), 2 (4ft) | 0.12 | 14.8 | 0.31 | 37.6 | | |
| 6' | 8" | 3 | 1 (0.5ft), 2 (3ft) | 0.09 | 10.5 | --- | --- | | |
| 6' | 10",12",14",16" | 3 | 1 (1ft), 2 (3ft) | 0.09 | 11.3 | --- | --- | | |
| 8' | Top Sill | 5 | 1 (2ft), 4 (3ft) | 0.22 | 26.6 | 0.56 | 67.5 | | |
| 8' | 8" | 3 | 1 (0.5ft), 2 (5ft) | 0.13 | 16.1 | --- | --- | | |
| 8' | 10",12",14",16" | 3 | 1 (1ft), 2 (5ft) | 0.14 | 16.9 | --- | --- | | |
| 12' | Top Sill | 7 | 1 (2ft), 6 (3ft) | 0.32 | 38.4 | 0.81 | 97.4 | | |
| 12' | 8" | 5 | 1 (0.5ft), 2 (4ft), 2 (5ft) | 0.23 | 27.9 | --- | --- | | |
| 12' | 10",12",14",16" | 5 | 1 (1ft), 2 (4ft), 2 (5ft) | 0.24 | 28.7 | --- | --- | | |

| GUIDELINES AND CONTROL SETTING | | | | | | |
|--------------------------------|--------------|----------|----------------------------------|-----------------|--------------------|------------------------------|
| Application | BTUH/ft | | Super Heat Set Point @ bulb (°F) | Evaporator (°F) | Discharge Air (°F) | Discharge Air Velocity (FPM) |
| | Conventional | Parallel | | | | |
| Meat | 2024 | 1827 | 6 - 8 | 17 | 25 | 130 |
| Deli | 1882 | 1699 | 6 - 8 | 22 | 28 | 130 |

| DEFROST CONTROLS | | | | | | | |
|------------------|--------------------|--------------------|-----------------------|-------------------|-----------------------|-----------------|-----------------------|
| Defrost Per Day | Run-Off Time (Min) | Electrical Defrost | | Timed-Off Defrost | | Hot Gas Defrost | |
| | | Fail-Safe (Min) | Termination Temp (°F) | Fail-Safe (Min) | Termination Temp (°F) | Fail-Safe (Min) | Termination Temp (°F) |
| 4 | 6 - 8 | 30 | 47 | 45 | 45 | 26 | 45 |

NOTES

- "----" indicates that the feature is not an option on this case model and/or the data is not yet available.
- Listed LED lighting values represent a full row of shelves (including wrap-around ends).
- Listed BTUH/ft data represents unlighted shelves. For LED lighting, add 9 BTUH/ft per row of lighted shelving.
- Load data represents the sum of both coils.
- Listed evaporator temperature represents unlighted shelves. For lighted shelves and/or aftermarket merchandising accessories, reduce the listed evaporator temperature by 2°F. BTUH load increases by 132 BTUH/ft when aftermarket merchandising accessories are utilized.
- Listed discharge air velocity represents the average velocity at the peak of defrost.
- Temperature and defrost settings listed above are recommended start-up settings. Final operational settings may need to be adjusted for the store conditions in which the case operates.
- The recommended evaporator temperatures may need to be adjusted based on system setup, store conditions, etc. The minimum recommended evaporator temperature is 4°F below the listed evaporator temperature.



ALL MEASUREMENTS ARE TAKEN PER ASHRAE-72-2005 SPECIFICATIONS. HILLPHOENIX REFRIGERATED DISPLAY CASES FOR SALE IN THE UNITED STATES MEET OR EXCEED DEPARTMENT OF ENERGY 2017 REQUIREMENTS.

O4IDB

| Rev Date: | Rev # | Revision Description: |
|-----------|-------|-----------------------|
| 7-25-18 | 2 | NEW STANDARDS |
| 12-1-17 | 1 | DOE 2017 |



O4IDB

Wide Multi-Deck Island Merchandiser
6', 8' & 12' (Deli / Meat) Single Wrap-Around End

| SECOND NATURE DATA | | | | | | | | |
|--------------------|--------------|-------------|-----------------|--------------|----------|-------------|------------------------|-------------------------|
| Case Model | No. Of Coils | Application | Front Sill Type | BTUH/ft (DR) | | GPM/ft (DR) | Supply Fluid Temp (°F) | Discharge Air Temp (°F) |
| | | | | Conventional | Parallel | | | |
| O4IDB | 2 | Meat | 6" Thermopane | 1882 | 1699 | 1.41 | 20 | 25 |
| O4IDB | 2 | Deli | 6" Thermopane | 2024 | 1827 | 1.51 | 20 | 28 |

| SECOND NATURE DATA | | | | | | | | |
|--------------------|--------------|-------------|-----------------|-----------------|-------------------|-----------------------|--------------------|-----------------------|
| Case Model | No. of Coils | Application | Front Sill Type | No. of Defrosts | Timed Off Defrost | | Warm Fluid Defrost | |
| | | | | | Fail-Safe (Min) | Termination Temp (°F) | Fail-Safe (Min) | Termination Temp (°F) |
| O4IDB | 2 | Meat | 6" Thermopane | 4 | 60 | 47 | 26 | 49 |
| O4IDB | 2 | Deli | 6" Thermopane | 4 | 60 | 47 | 26 | 49 |



ALL MEASUREMENTS ARE TAKEN PER ASHRAE-72-2005 SPECIFICATIONS. HILLPHOENIX REFRIGERATED DISPLAY CASES FOR SALE IN THE UNITED STATES MEET OR EXCEED DEPARTMENT OF ENERGY 2017 REQUIREMENTS.

O4IDB

| Rev Date: | Rev # | Revision Description: |
|-----------|-------|-----------------------|
| 7-25-18 | 2 | NEW STANDARDS |
| 12-1-17 | 1 | DOE 2017 |

Hillphoenix
A BOWEN COMPANY

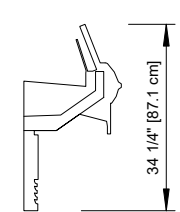
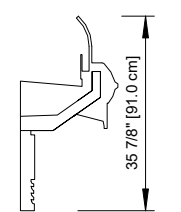
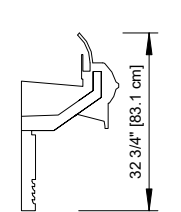
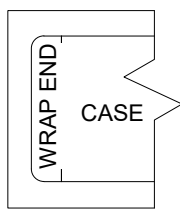
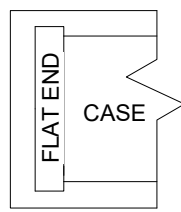
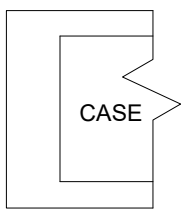
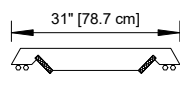
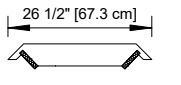
| FRONT OPTIONS | | |
|--|---|--|
| <p><u>ANGLED THERMOPANE</u></p>  <p>34 1/4" [87.1 cm]</p> | <p><u>8.75" CURVED PLEXI</u></p>  <p>35 7/8" [91.0 cm]</p> | <p><u>5.5" CURVED PLEXI</u></p>  <p>32 3/4" [83.1 cm]</p> |
| END OPTIONS | | |
| <p><u>SINGLE WRAP END</u></p>  <p>WRAP END CASE</p> | <p><u>SINGLE FLAT END</u></p>  <p>FLAT END CASE</p> | <p><u>SINGLE JOINT (SINGLE BUTT)</u></p>  <p>CASE</p> |
| CENTER TOWER OPTIONS | | |
| <p><u>31" LIGHTED TOWER</u></p>  <p>31" [78.7 cm]</p> | <p><u>24" TOWER</u></p>  <p>26 1/2" [67.3 cm]</p> | |



2017 DOE COMPLIANT COMPONENT
ALL MEASUREMENTS ARE TAKEN PER ASHRAE-72-2005 SPECIFICATIONS. HILLPHOENIX REFRIGERATED DISPLAY CASES FOR SALE IN THE UNITED STATES MEET OR EXCEED DEPARTMENT OF ENERGY 2017 REQUIREMENTS.

O4IDB

| Rev Date: | Rev # | Revision Description: |
|-----------|-------|-----------------------|
| 7-25-18 | 2 | NEW STANDARDS |
| 12-1-17 | 1 | DOE 2017 |

O4IDB

Wide Multi-Deck Island Merchandiser 6', 8' & 12' (Deli / Meat) Single Wrap-Around End

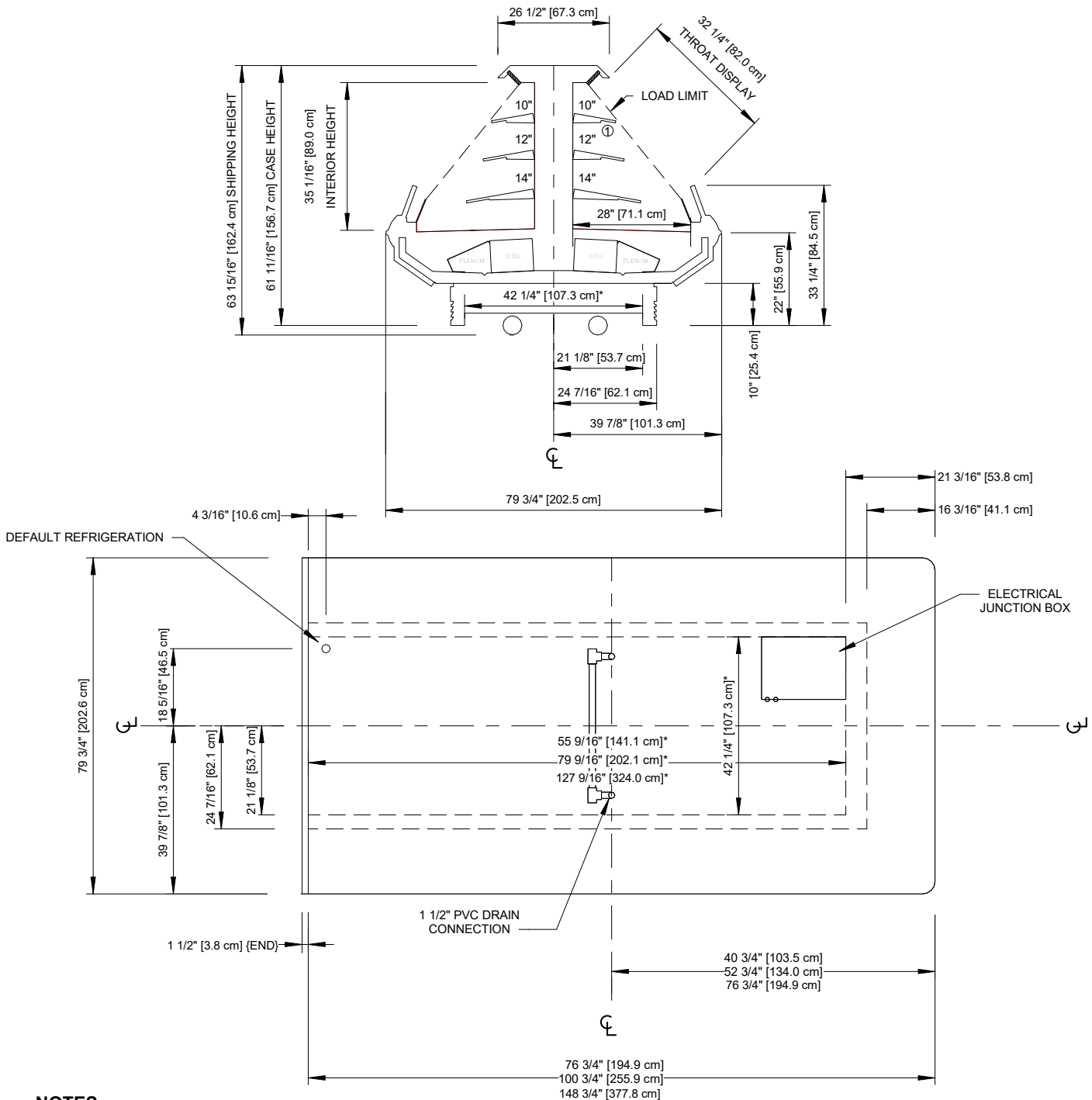

NOTES

- * : STUB-UP AREA
- Ⓢ : AVAILABLE SHELF SIZES: 10", 12", 14", 16"

- Front and center sill heights vary with base frame height.



ALL MEASUREMENTS ARE TAKEN PER ASHRAE-72-2005 SPECIFICATIONS. HILLPHOENIX REFRIGERATED DISPLAY CASES FOR SALE IN THE UNITED STATES MEET OR EXCEED DEPARTMENT OF ENERGY 2017 REQUIREMENTS.

O4IDB

| Rev Date: | Rev # | Revision Description: |
|-----------|-------|-----------------------|
| 7-25-18 | 2 | NEW STANDARDS |
| 12-1-17 | 1 | DOE 2017 |

