

ON3.5UM-NRG

Medium Temp Unitized Island Merchandiser
4', 6', 8', 12' Dairy/Deli/Meat/Produce

GENERAL NOTES

- "---" indicates that the feature is not an option for this case model and/or the data is not yet available.

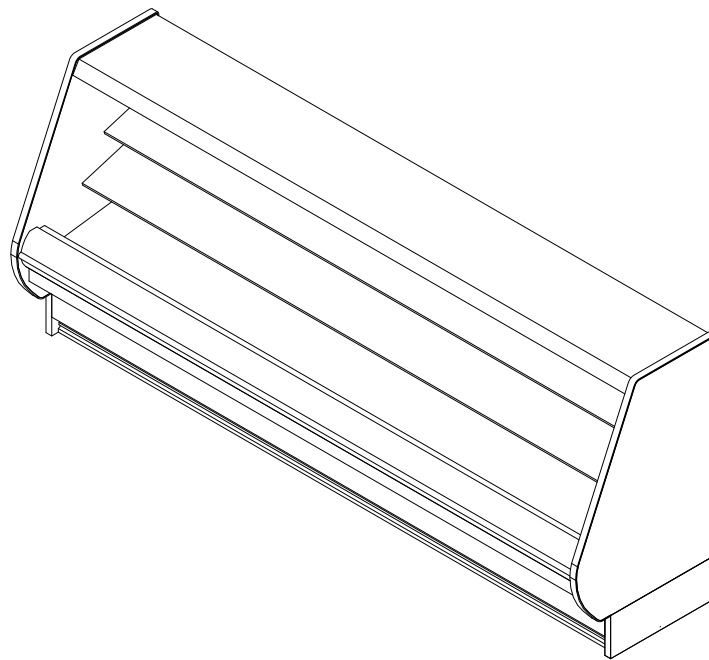

SHIPPING WEIGHT	
Case	Weight
ON3.5UM-NRG	---



ALL MEASUREMENTS ARE TAKEN PER ASHRAE-72-2005 SPECIFICATIONS. HILLPHOENIX REFRIGERATED DISPLAY CASES FOR SALE IN THE UNITED STATES MEET OR EXCEED DEPARTMENT OF ENERGY 2017 REQUIREMENTS.

ON3.5UM-NRG

Rev Date:	Rev #	Revision Description:
9-10-18	3	DATA UPDATE
4-18-18	2	NEW STANDARDS

Hillphoenix
A DOWER COMPANY

ON3.5UM-NRG

Medium Temp Unitized Island Merchandiser
4', 6', 8', 12' Dairy/Deli/Meat/Produce

ELECTRICAL DATA			
Case Length	Fans Per Case	High Efficiency Fans	
		120 Volts	
		Amps	Watts
4'	1	0.20	14.0
6'	2	0.40	28.0
8'	2	0.40	28.0
12'	3	0.60	42.0

LIGHTING DATA						
Case Length	Lights per row	Lights Length	Clearvoyant LED Lighting (Per Light Row)			
			Standard Power (Cornice or Shelf)		High Power (Cornice)	
			120 Volts		120 Volts	
			Amps	Watts	Amps	Watts
4'	1	4'	0.05	5.9	0.12	14.9
6'	2	3'	0.08	9.4	0.20	23.8
8'	2	4'	0.10	11.8	0.25	29.9
12'	3	4'	0.15	17.6	0.37	44.8

GUIDELINES AND CONTROL SETTINGS							
Application	Front Sill Height	BTUH/ft		Superheat Set Point @ Bulb (°F)	Evaporator (°F)	Discharge Air (°F)	Discharge Air Velocity (FPM)
		Conventional	Parallel				
Deli/Dairy/Produce	All	820	760	6 - 8	28	31	260
Meat	Extended	810	730	6 - 8	26	30	260

DEFROST CONTROLS		
Defrosts Per Day	Timed-Off Defrost	
	Fail-Safe (Min)	Termination Temp (°F)
6	30	47

NOTES

- "----" indicates option is not available.
- LED lights only.
- Listed BTUH/ft data represent unlighted shelves. For LED lighting, add 9 BTUH/ft per row of lighted shelving.
- BTUH load increases by 132 BTUH/ft when aftermarket merchandising accessories are utilized.
- Listed evaporator temperature represents unlighted shelves. For lighted shelves and/or aftermarket merchandising accessories, reduce the listed evaporator temperature by 2°F.
- Conventional Discharge Air Control – Recommended Settings: Cut-In Temp = Discharge Air + 2°F; Cut-Out Temp = Discharge Air - 2°F.
- Listed discharge air velocity represents the average velocity immediately after defrost.
- Temperature and defrost settings listed above are recommended start-up settings. Final operational settings may need to be adjusted for the store conditions in which the case operates.
- The recommended evaporator temperatures may need to be adjusted based on system setup, store conditions, etc. The minimum recommended evaporator temperature is 4°F below the listed evaporator temperature.



ALL MEASUREMENTS ARE TAKEN PER ASHRAE-72-2005 SPECIFICATIONS. HILLPHOENIX REFRIGERATED DISPLAY CASES FOR SALE IN THE UNITED STATES MEET OR EXCEED DEPARTMENT OF ENERGY 2017 REQUIREMENTS.

ON3.5UM-NRG

Rev Date:	Rev #	Revision Description:
9-10-18	3	DATA UPDATE
4-18-18	2	NEW STANDARDS

Hillphoenix
A DOWER COMPANY

ON3.5UM-NRG

Medium Temp Unitized Island Merchandiser
4', 6', 8', 12' Dairy/Deli/Meat/Produce

SECOND NATURE DATA								
Case Model	No. of Coils	Application	Front Sill Type	BTUH/FT (DR)		GPM/ft (DR)	Supply Fluid Temp (°F)	Discharge Air Temp (°F)
				Conventional	Parallel			
ON3.5UM-NRG	1	Deli	Standard	820	760	0.21	20	31
ON3.5UM-NRG	1	Meat	3" Extended	810	730	0.25	20	30
ON3.5UM-NRG	1	Deli	Standard	820	760	0.55	25	31
ON3.5UM-NRG	1	Meat	3" Extended	810	730	0.76	25	30

SECOND NATURE DATA								
Case Model	No. of Coils	Application	Front Sill Type	No. of Defrost	Timed-Off Defrost		Warm Fluid Defrost	
					Fail Safe (Min)	Termination Temp (°F)	Fail Safe (Min)	Termination Temp (°F)
ON3.5UM-NRG	1	Deli	Standard	6	60	47	26	49
ON3.5UM-NRG	1	Meat	3" Extended	6	60	47	26	49
ON3.5UM-NRG	1	Deli	Standard	6	45	42	26	49
ON3.5UM-NRG	1	Meat	3" Extended	6	45	42	26	49



ALL MEASUREMENTS ARE TAKEN PER ASHRAE-72-2005 SPECIFICATIONS. HILLPHOENIX REFRIGERATED DISPLAY CASES FOR SALE IN THE UNITED STATES MEET OR EXCEED DEPARTMENT OF ENERGY 2017 REQUIREMENTS.

ON3.5UM-NRG

Rev Date:	Rev #	Revision Description:
9-10-18	3	DATA UPDATE
4-18-18	2	NEW STANDARDS

Hillphoenix
A DOWER COMPANY

ON3.5UM-NRG

Medium Temp Unitized Island Merchandiser
4', 6', 8', 12' Dairy/Deli/Meat/Produce

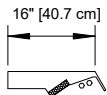
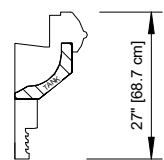
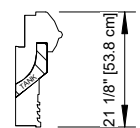
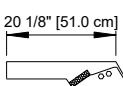
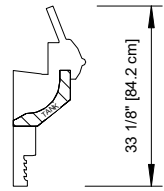
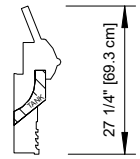
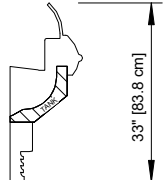
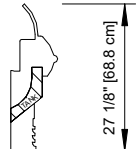
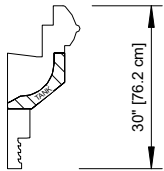
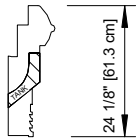
REAR SILL OPTIONS	FRONT OPTIONS	
	<u>11" BASEFRAME</u>	<u>5" BASEFRAME</u>
<p>16" REAR SILL (FRONT DISCHARGE)</p> 	<p><u>STANDARD FRONT</u></p> 	<p><u>STANDARD FRONT</u></p> 
<p>20" REAR SILL (FRONT DISCHARGE)</p> 	<p><u>6" THERMOPANE FRONT</u></p> 	<p><u>6" THERMOPANE FRONT</u></p> 
	<p><u>6" PLEXIGLAS FRONT</u></p> 	<p><u>6" PLEXIGLAS FRONT</u></p> 
	<p><u>EXTENDED STANDARD FRONT</u></p> 	<p><u>EXTENDED STANDARD FRONT</u></p> 

NOTES:

- Front and rear sill heights vary with base frame height.
- Extended front sills are required on meat applications to maintain proper product temperature. An extended front has a minimum height of 24" on a 5" baseframe, or 30" on an 11" baseframe.



ALL MEASUREMENTS ARE TAKEN PER ASHRAE-72-2005 SPECIFICATIONS. HILLPHOENIX REFRIGERATED DISPLAY CASES FOR SALE IN THE UNITED STATES MEET OR EXCEED DEPARTMENT OF ENERGY 2017 REQUIREMENTS.

ON3.5UM-NRG

Rev Date:	Rev #	Revision Description:
9-10-18	3	DATA UPDATE
4-18-18	2	NEW STANDARDS

Hillphoenix
A DOWER COMPANY

ON3.5UM-NRG

Medium Temp Unitized Island Merchandiser
4', 6', 8', 12' Dairy/Deli/Meat/Produce

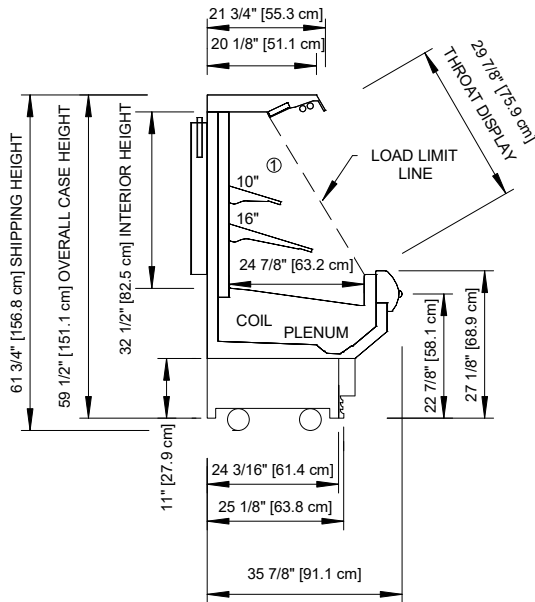

11" BASE FRAME

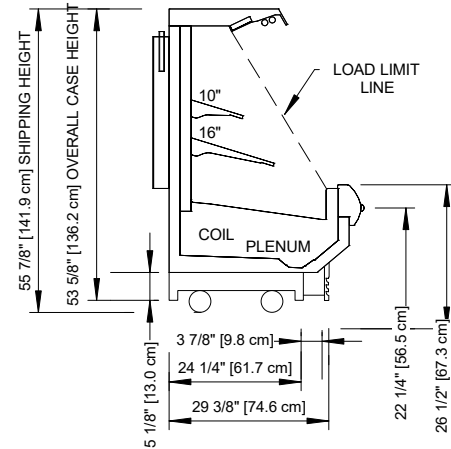

5" BASE FRAME

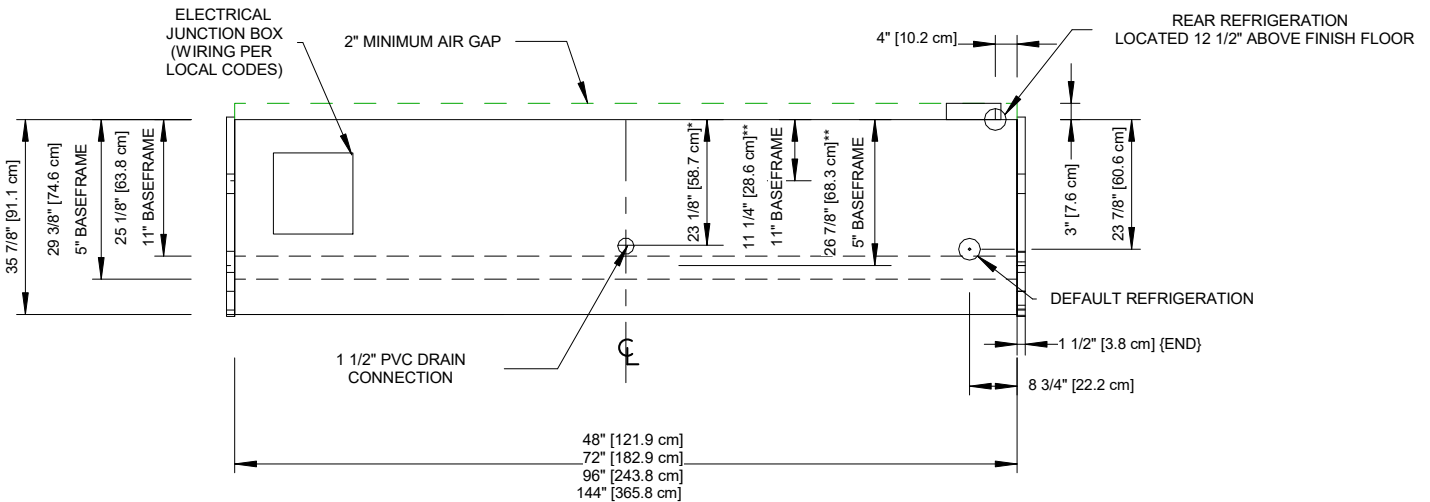

NOTES

- * : STUB-UP AREA
- ** : RECOMMENDED STUB-UP CENTERLINE FOR ELECTRICAL AND HUB DRAINS
- ① : AVAILABLE SHELF SIZES: 10", 12", 14", 16", & 18"

- Ends add approximately 1" to case height, 1" to the front & 1/2" to the back.
- Product on top shelf should be 3" below discharge.



ALL MEASUREMENTS ARE TAKEN PER ASHRAE-72-2005 SPECIFICATIONS. HILLPHOENIX REFRIGERATED DISPLAY CASES FOR SALE IN THE UNITED STATES MEET OR EXCEED DEPARTMENT OF ENERGY 2017 REQUIREMENTS.

ON3.5UM-NRG

Rev Date:	Rev #	Revision Description:
9-10-18	3	DATA UPDATE
4-18-18	2	NEW STANDARDS

