

Replacement Parts ^{series} Advantage

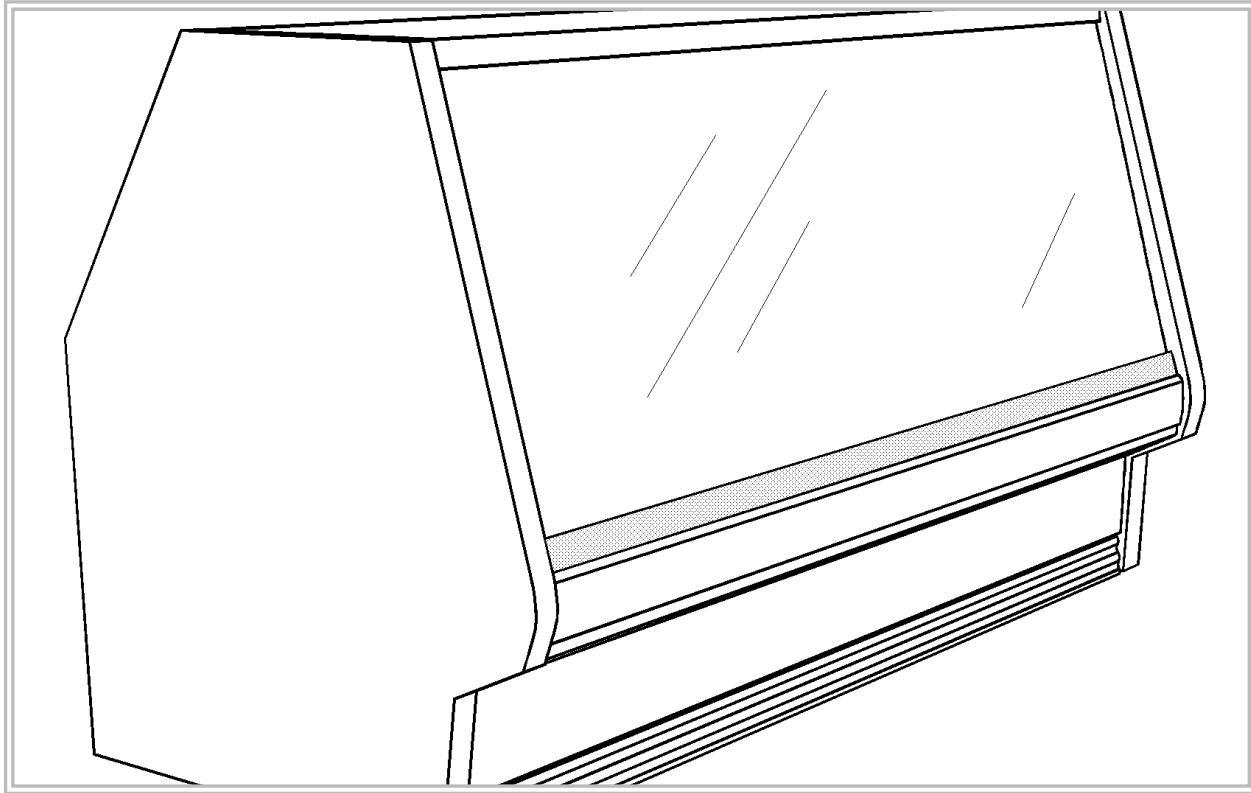

Vertical Front Glass Meat/Seafood/Deli Service Merchandiser

Production began OCTOBER 6, 2000

NVM • NVF • NVD

9000509	NVM6	Med-Temp	6' Vertical Glass Meat Service Merchandiser
9000510	NVM8	Med-Temp	8' Vertical Glass Meat Service Merchandiser
9000511	NVM12	Med-Temp	12' Vertical Glass Meat Service Merchandiser
9000512	NVF6	Med-Temp	6' Vertical Glass Deli Service Merchandiser
9000513	NVF8	Med-Temp	8' Vertical Glass Deli Service Merchandiser
9000514	NVF12	Med-Temp	12' Vertical Glass Deli Service Merchandiser
9000515	NVD6	Med-Temp	6' Vertical Glass Seafood Service Merchandiser
9000516	NVD8	Med-Temp	8' Vertical Glass Seafood Service Merchandiser
9000517	NVD12	Med-Temp	12' Vertical Glass Seafood Service Merchandiser



Issue date: OCTOBER 2000

Replaces issue:

Part number: 9037182

Revision:

Tyler Refrigeration Corporation Niles, MI 49120
Parts information subject to change without notice
Printed in U.S.A.



CONTENTS

	<u>Page</u>
Cladding, Covers and Trims	C1-C5
Structural Components	
Front Glass	S1
Rear Doors & Outside Mullion Covers	S2
Rear Inside Mullion Covers	S3
Ducts and Z-Bars	S4-S5
Patch Ends, Partitions and Dividers	
Solid Patch Ends	S6
Solid Patch Ends with Glass	S7
1" Solid Partitions	S8
Floating Plexiglas Dividers	S9
Electrical System Components	
Wiring Harnesses	
Wiring and Components	E1
Fan Systems	E2
Top Light	E3-E4
Refrigeration System Components	
Coil Assemblies	R1-R3
Optional Case Accessories	
Shelf Assemblies	A1-A5
Screens, Fences, and Trays	A6-A8
Thermometers	A9-A10



CLADDING, COVERS AND TRIMS STANDARD CASE HEIGHT- 52"

NVM/NVF/NVD

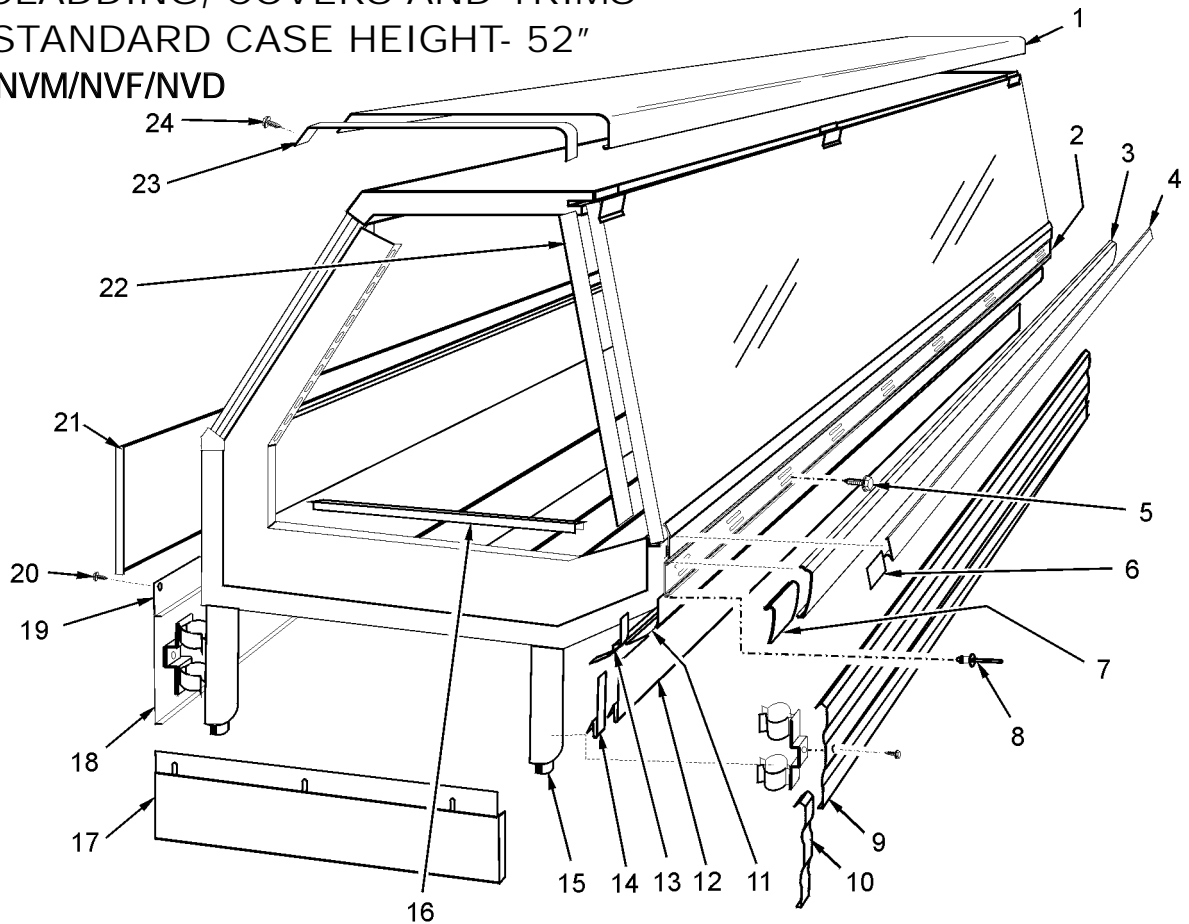

6', 8' and 12' Merchandiser

Item	Part No.	Quantity.			Description	Item	Part No.	Quantity.			Description
		6'	8'	12'				6'	8'	12'	
1	9027519	1	-	-	Rear Top Cladding-MB/SS	13	9043829	1	1	1	UPR FR CLDG JT Trim
	9026513	-	1	-	Rear Top Cladding-MB/SS		9029415	4	4	4	Screw
	9027520	-	-	1	Rear Top Cladding-MB/SS		9043828	1	1	1	UPR FR CLDG End Trim
2	9025052	1	-	-	Bumper RTNR-Misty Gray		9024814	2	2	2	Screw
	9025058	-	1	-	Bumper RTNR-Misty Gray	14	9044273	1	1	1	LWR FR CLDG JT Trim-52"
	9025061	-	-	1	Bumper RTNR-Misty Gray		9029415	4	4	4	Screw
3	+	1	1	1	Bumper		9043892	1	1	1	LWR FR CLDG End Trim-52"
4	9025979	1	-	-	Color Band, Ptd.		9024814	2	2	2	Screw
	9025980	-	1	-	Color Band, Ptd.	15	9024894	6	6	8	Pipe Legs- 9 3/4"
	9025981	-	-	1	Color Band, Ptd.	16	9037279	1	1	1	LWR JT Cover
5	9025833	12	12	14	Screw	17	9043066	1	1	1	LH Base End Close-off
6	9025655	1	1	1	Color Band Backer, Ptd.		9024986	1	1	1	RH Base End Close-off
7	+	1	1	1	Bumper Backer		5208265	3	3	3	Screw
8	5104702	6	8	12	Rivet		5243597	3	3	3	Flat Washer
9	9024937	1	-	-	Kickplate Assy.-52"		5100661	3	3	3	Nut
	9024938	-	1	-	Kickplate Assy.-52"	18	9024934	1	-	-	RR Base Close-off Assy.,-52"
	9024939	-	-	1	Kickplate Assy.-52"		9024935	-	1	-	RR Base Close-off Assy.,-52"
10	9043816	1	1	1	Kickplate Joint Trim		9024936	-	-	1	RR Base Close-off Assy.,-52"
	5619204	4	4	4	Screw	19	9024929	1	-	2	Rear Rail Cover-6'
11	9024922	1	-	-	UPR FR Cladding, Ptd.		9024928	-	2	-	Rear Rail Cover-4'
	9024923	-	1	-	UPR FR Cladding, Ptd.	20	9043080	16	24	32	Screw
	9024924	-	-	1	UPR FR Cladding, Ptd.	21	9024770	1	-	-	Lower Rear Shell Cover
	9023806	3	3	4	Screw		9024771	-	1	-	Lower Rear Shell Cover
12	9043822	1	-	-	LWR FR Cladding, Ptd.-52"		9024772	-	-	1	Lower Rear Shell Cover
	9043823	-	1	-	LWR FR Cladding, Ptd.-52"	22	9028859	1	1	1	Front Joint Trim-BLK
	9024824	-	-	1	LWR FR Cladding, Ptd.-52"		9026591	1	1	1	Double Sided Tape
						23	9037299	1	1	1	Top Joint Trim
						24	5199134	4	4	4	Screw

+ See pages C2 thru C4 for parts breakdown per color.



CLADDING, COVERS AND TRIMS
 OPTIONAL CASE HEIGHT- 3 3/4" LOWER
 NVM/NVF/NVD

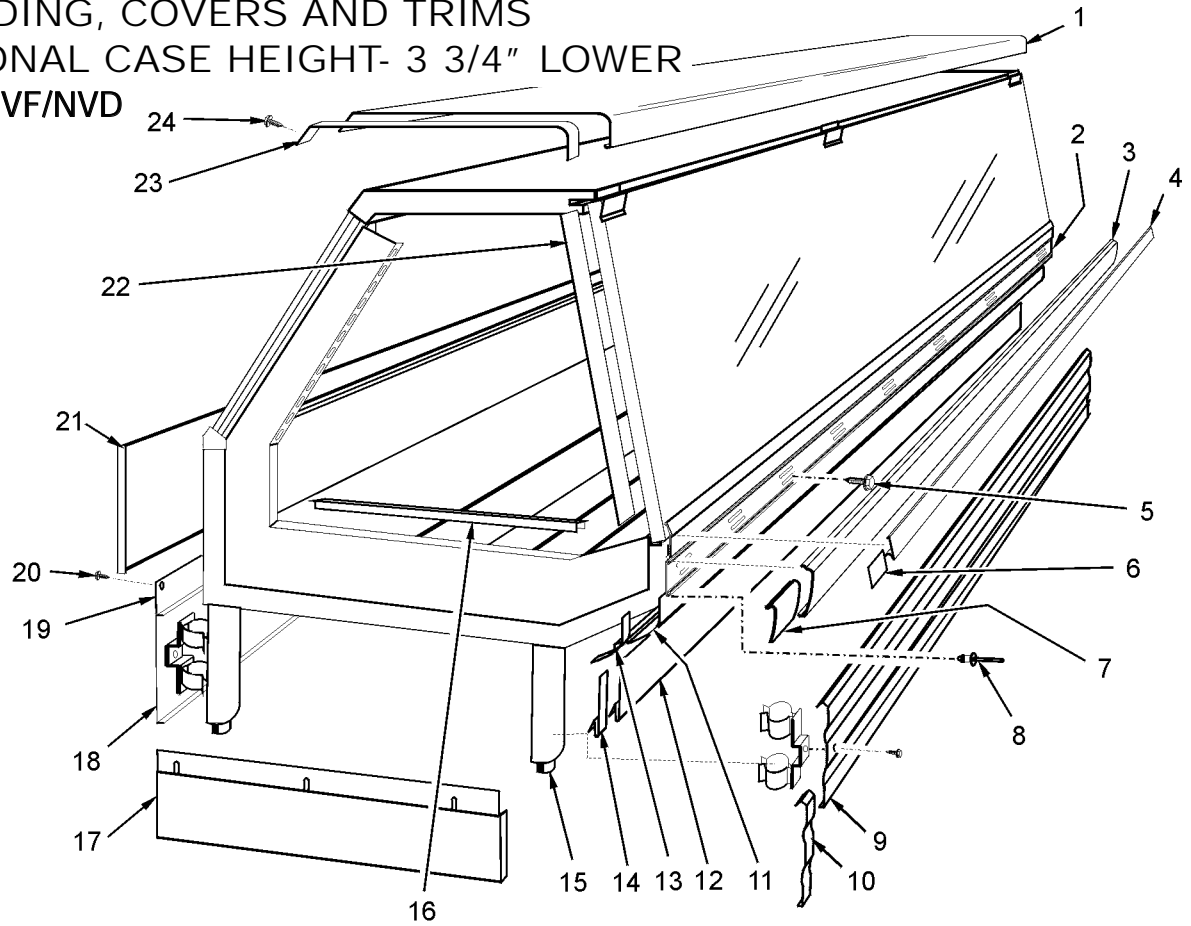

6', 8' and 12' Merchandiser

Item	Part No.	Quantity.			Description	Item	Part No.	Quantity.			Description
		6'	8'	12'				6'	8'	12'	
1	9027519	1	-	-	Rear Top Cladding-MB/SS	13	9043829	1	1	1	UPR FR CLDG JT Trim
	9026513	-	1	-	Rear Top Cladding-MB/SS		9029415	4	4	4	Screw
	9027520	-	-	1	Rear Top Cladding-MB/SS		9043828	1	1	1	UPR FR CLDG End Trim
2	9025052	1	-	-	Bumper RTNR-Misty Gray		9024814	2	2	2	Screw
	9025058	-	1	-	Bumper RTNR-Misty Gray	14	9044274	1	1	1	LWR FR CLDG JT Trim-48"
	9025061	-	-	1	Bumper RTNR-Misty Gray		9029415	4	4	4	Screw
3	+	1	1	1	Bumper		9043890	1	1	1	LWR FR CLDG End Trim-48"
4	9025979	1	-	-	Color Band, Ptd.		9024814	2	2	2	Screw
	9025980	-	1	-	Color Band, Ptd.	15	9024893	6	6	8	Pipe Legs- 6"
	9025981	-	-	1	Color Band, Ptd.	16	9037279	1	1	1	LWR JT COVER
5	9025833	12	12	14	Screw	17	9024980	1	1	1	Base End Close-off-48"
6	9025655	1	1	1	Color Band Backer, Ptd.		5208265	3	3	3	Screw
7	+	1	1	1	Bumper Backer		5243597	3	3	3	Flat Washer
8	5104702	6	8	12	Rivet		5100661	3	3	3	Nut
9	9024937	1	-	-	Kickplate Assy.-48"	18	9024963	1	-	-	RR Base Close-off Assy.-48"
	9024938	-	1	-	Kickplate Assy.-48"		9024964	-	1	-	RR Base Close-off Assy.-48"
	9024939	-	-	1	Kickplate Assy.-48"		9024965	-	-	1	RR Base Close-off Assy.-48"
10	9043816	1	1	1	Kickplate Joint Trim	19	9024929	1	-	2	Rear Rail Cover-6'
	5619204	4	4	4	Screw		9024928	-	2	-	Rear Rail Cover-4'
11	9024922	1	-	-	UPR FR Cladding, Ptd.	20	9043080	16	24	32	Screw
	9024923	-	1	-	UPR FR Cladding, Ptd.	21	9024770	1	-	-	Lower Rear Shell Cover
	9024924	-	-	1	UPR Front Cladding, Ptd.		9024771	-	1	-	Lower Rear Shell Cover
	9023806	3	3	4	Screw		9024772	-	-	1	Lower Rear Shell Cover
12	9043825	1	-	-	LWR FR Cladding, Ptd.-48"	22	9028859	1	1	1	Front Joint Trim-BLK
	9043826	-	1	-	LWR FR Cladding, Ptd.-48"		9026591	1	1	1	Double Sided Tape
	9043827	-	-	1	LWR FR Cladding, Ptd.-48"	23	9037299	1	1	1	Top Joint Trim
						24	5199134	4	4	4	Screw

+ See pages C2 thru C4 for parts breakdown per color.



CLADDING, COVERS AND TRIMS - (CONT'D)
NVM/NVF/NVD - 6'

**Bumper [Item 3]
Without Partition
(72.312"):**

Part No.	Color
9025031	White
9025261	Bone White
9025282	Misty Gray
9025303	Pearl
9025324	Oatmeal
9025345	Soft Sand
9025366	Chromium
9025387	Cool Gray
9025408	Oyster
9025429	Black
9026501	Pearly Gates
9028899	Steel Gray
9031680	Chocolate
9031717	Mocha
9031754	Stone
9029494	Cherry Red
9044002	Teal

**With Partition
(73.312"):**

Part No.
9027159
9027160
9027161
9027162
9027163
9027164
9027165
9027166
9027167
9027168
9029331
9028901
9031682
9031719
9031756
9029496

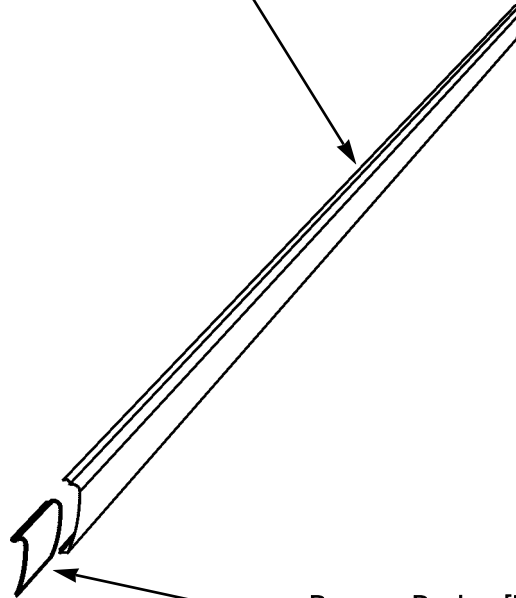

Bumper Backer [Item 7]

Part No.	Color
9025023	White
9025028	Bone White
9025035	Misty Gray
9025038	Pearl
9025041	Oatmeal
9025079	Pearly Gates
9025253	Soft Sand
9025258	Chromium
9025265	Cool Gray
9025268	Oyster
9025271	Black
9028883	Steel Gray
9031884	Chocolate
9031885	Mocha
9031886	Stone
9029581	Cherry Red
9044004	Teal



CLADDING, COVERS AND TRIMS - (CONT'D)

NVM/NVF/NVD - 8'

**Bumper [Item 3]
Without Partition
(96.437"):**

Part No.	Color
9025037	White
9025267	Bone White
9025288	Misty Gray
9025309	Pearl
9025330	Oatmeal
9025351	Soft Sand
9025372	Chromium
9025393	Cool Gray
9025414	Oyster
9025435	Black
9028906	Steel Gray
9029335	Pearly Gates
9031688	Chocolate
9031725	Mocha
9031762	Stone
9029502	Cherry Red
9044003	Teal

**With Partition
(97.437"):**

Part No.
9027189
9027190
9027191
9027192
9027193
9027194
9027195
9027196
9027197
9027198
9028908
9029337
9031690
9031727
9031764
9029504

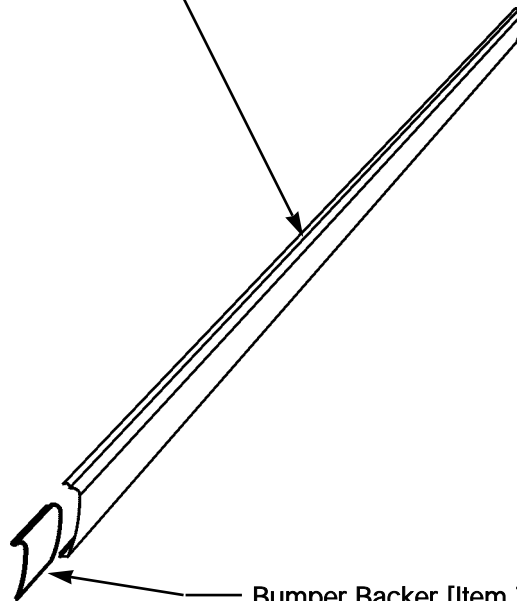

Bumper Backer [Item 7]

Part No.	Color
9025023	White
9025028	Bone White
9025035	Misty Gray
9025038	Pearl
9025041	Oatmeal
9025079	Pearly Gates
9025253	Soft Sand
9025258	Chromium
9025265	Cool Gray
9025268	Oyster
9025271	Black
9028883	Steel Gray
9031884	Chocolate
9031885	Mocha
9031886	Stone
9029581	Cherry Red
9044004	Teal



CLADDING, COVERS AND TRIMS - (CONT'D)

NVM/NVF/NVD - 12'

Bumper [Item 3]

Without Partition
(144.562"):

Part No.	Color
9025040	White
9025069	Pearly Gates
9025270	Bone White
9025291	Misty Gray
9025312	Pearl
9025333	Oatmeal
9025354	Soft Sand
9025375	Chromium
9025396	Cool Gray
9025417	Oyster
9025438	Black
9028913	Steel Gray
9031696	Chocolate
9031733	Mocha
9031770	Stone
9029510	Cherry Red

With Partition
(145.563"):

Part No.
9027209
9029341
9027210
9027211
9027212
9027213
9027214
9027215
9027216
9027217
9027218
9028915
9031698
9031735
9031772
9029512

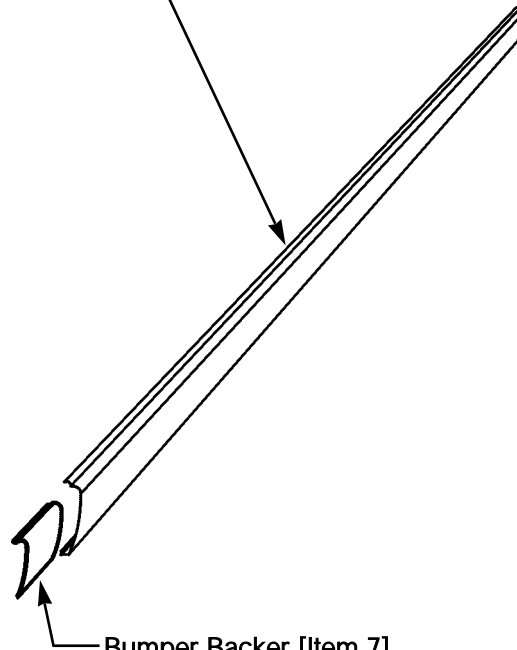

Bumper Backer [Item 7]

Part No.	Color
9025023	White
9025028	Bone White
9025035	Misty Gray
9025038	Pearl
9025041	Oatmeal
9025079	Pearly Gates
9025253	Soft Sand
9025258	Chromium
9025265	Cool Gray
9025268	Oyster
9025271	Black
9028883	Steel Gray
9031884	Chocolate
9031885	Mocha
9031886	Stone
9029581	Cherry Red
9044004	Teal



STRUCTURAL COMPONENTS
FRONT GLASS - NVM/NVF/NVD

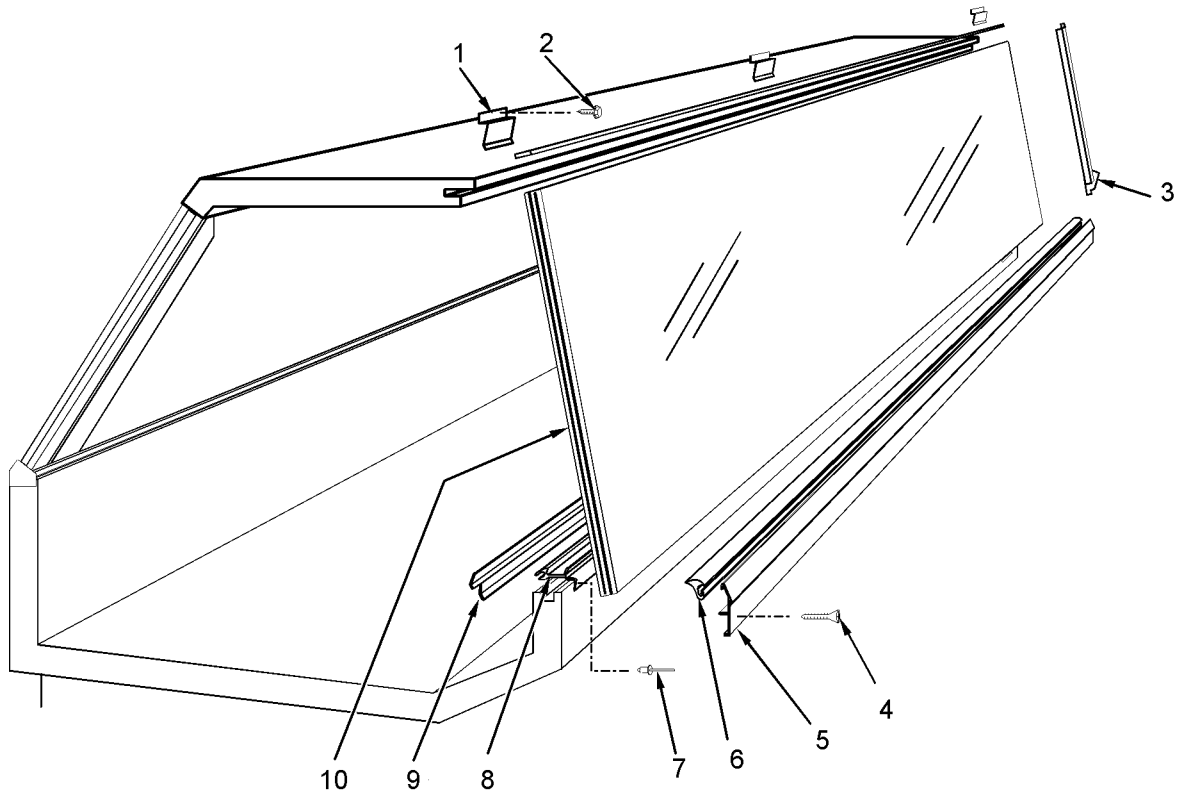

6', 8' and 12' Merchandiser

Item	Part No.	Quantity			Description	Item	Part No.	Quantity			Description
		6'	8'	12'				6'	8'	12'	
1	5966385	3	3	4	Top Front Glass Retainer	8	5221358	1	-	-	Front Glass Support
2	5183536	6	6	8	Screw		5962072	-	1	-	Front Glass Support
3	5966434	1	1	1	RH Glass Retainer Assy.		5962073	-	-	1	Front Glass Support
	5966435	1	1	1	LH Glass Retainer Assy.	9	5234819	1	-	-	Front Liner Cover
4	5612692	6	6	8	Screw		5234820	-	1	-	Front Liner Cover
5	5240403	1	-	-	Front Glass Retainer		5234821	-	-	1	Front Liner Cover
	5240404	-	1	-	Front Glass Retainer	10	5966390	1	-	-	Front Glass
	5240405	-	-	1	Front Glass Retainer		5239029	-	1	-	Front Glass
6	5238565	6'	8'	12'	Front Glass Seal		5966384	-	-	1	Front Glass
7	5199728	5	5	6	Rivet						



STRUCTURAL COMPONENTS - (CONT'D)
 REAR DOORS & OUTSIDE MULLION COVERS - NVM/NVF/NVD

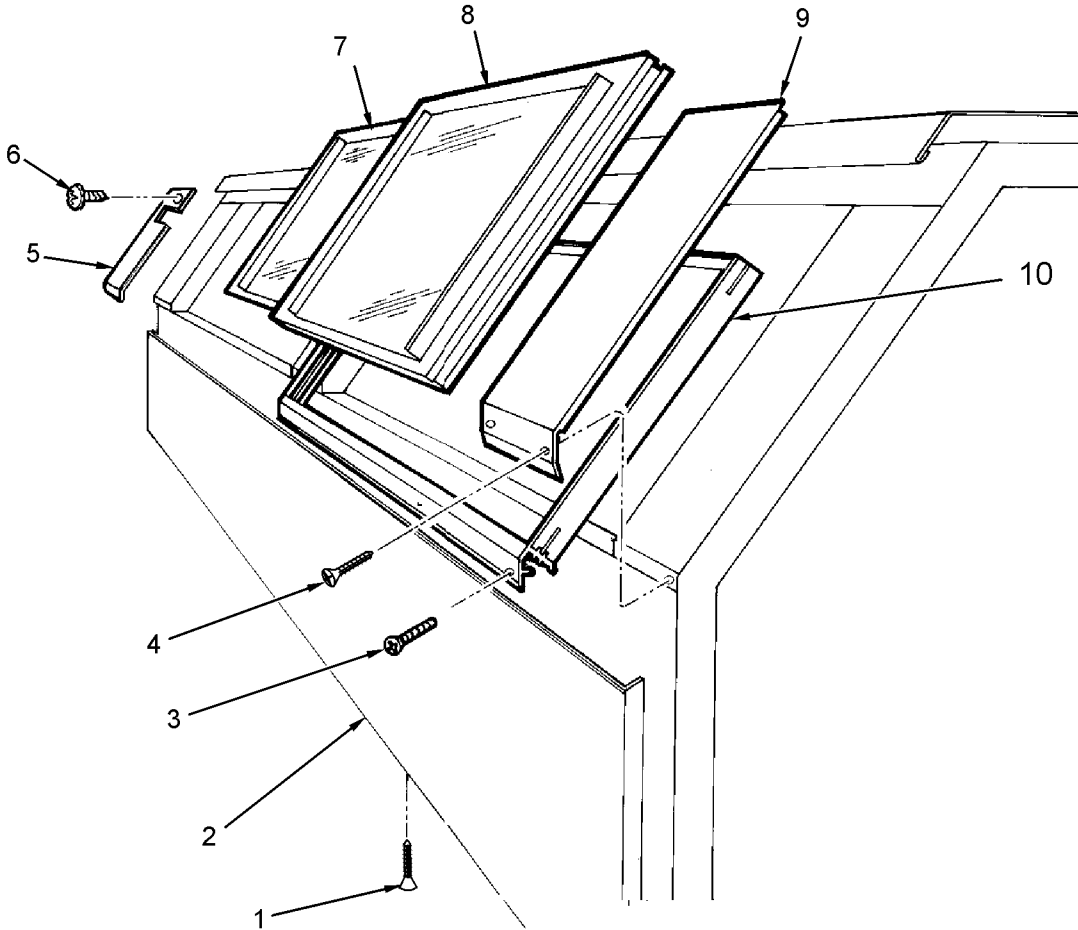

6', 8' and 12' Merchandiser

Item	Part No.	Quantity.			Description	Item	Part No.	Quantity.			Description
		6'	8'	12'				6'	8'	12'	
1	9043080	4	6	8	Screw	7	5232807	1	-	-	Inside Rear Door
2	9024770	1	-	-	LWR RR Shell Cover		5232808	-	2	3	Inside Rear Door
	9024771	-	1	-	LWR RR Shell Cover	8	5232811	1	-	-	Outside Rear Door
	9024772	-	-	1	LWR RR Shell Cover		5232812	-	2	3	Outside Rear Door
3	5237681	18	32	48	Screw	9	9410606	1	1	1	End Mullion Cover w/o Opening
4	9043080	2	2	2	Screw		9043080	4	4	4	Screw
5	9410607	1	1	1	RH End Mullion Cover w/Opening	10	5233082	1	-	-	Door Frame
6	9043080	4	4	4	Screw		5232987	-	2	3	Door Frame
	9410608	-	-1	1	Center Mullion Cover w/Opening		5233658	-	4	6	Shim
	9043080	4	4	4	Screw						



STRUCTURAL COMPONENTS - (CONT'D)
INSIDE MULLION COVERS - NVM/NVF/NVD

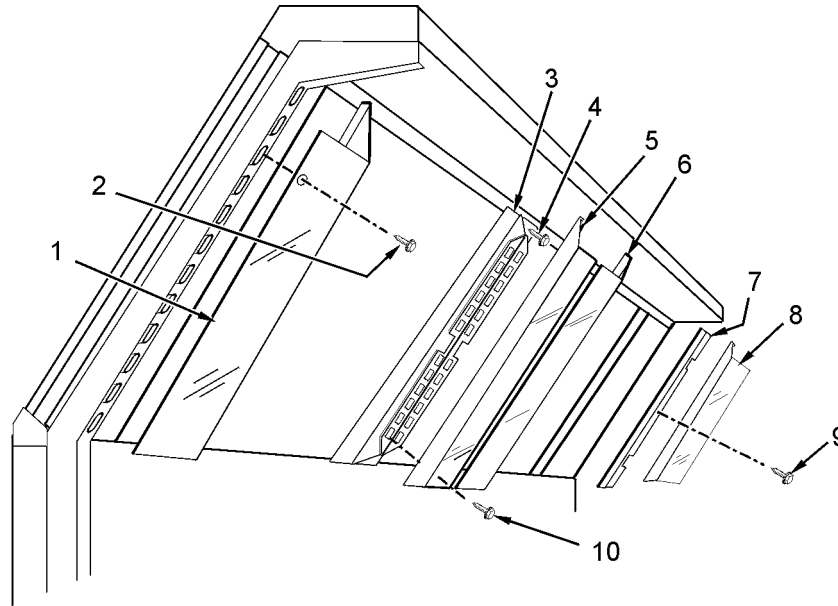

6', 8' and 12' Merchandiser

Item	Part No.	Quantity.			Description	Item	Part No.	Quantity.			Description
		6'	8'	12'				6'	8'	12'	
1	5240049	1	1	1	LH Mullion Cover	7	5233390	2	2	2	Mullion Cover Retainer
2	9024814	3	3	3	Screw	8	9025931	1	-	-	RH End Mullion Cover
3	5966437	-	1	2	Center Upright Weld		9025930	-	1	1	RH End Mullion Cover
					Assy.		9024814	3	3	3	Screw
4	1309067	-	4	8	Screw	9	9023806	6	6	6	Screw
5	9025929	-	1	1	Center LH Mullion Cover	10	9024814	-	6	12	Screw
	9025928	-	-	1	Center LH Mullion Cover						
6	5240054	-	1	-	Center RH Mullion Cover						
	5240050	-	-	1	Center RH Mullion Cover						
	5240058	-	-	1	Center RH Mullion Cover						



STRUCTURAL COMPONENTS - (CONT'D)
 DUCTS AND Z-BARS - NVM/NVF

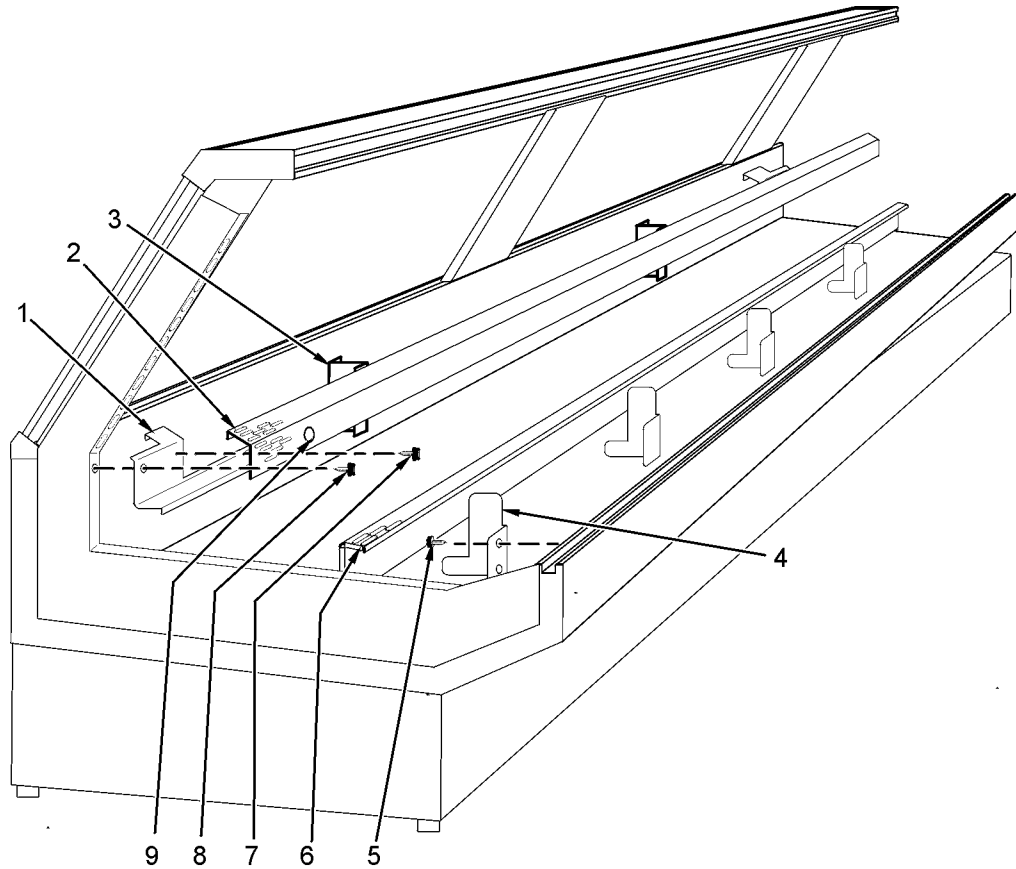

6', 8' and 12' Merchandiser

Item	Part No.	Quantity			Description	Item	Part No.	Quantity			Description
		6'	8'	12'				6'	8'	12'	
1	5240138	1	-	-	Rear Duct, Stationary		5234056	-	2	3	Plexiglas Support (NVF)
	5240139	-	1	-	Rear Duct, Stationary		5104702	6	8	12	Rivet (NVF)
	5240140	-	-	1	Rear Duct, Stationary		5221308	2	-	-	Plexiglas Guard (NVF)
	5233055	1	-	-	Rear Duct, Removable		5201011	-	2	3	Plexiglas Guard (NVF)
2	5232997	-	1	1	RH Rear Duct, Removable	4	5236956	4	6	9	Front Z-Bar
	5232998	-	1	1	LH Rear Duct, Removable	5	5183536	8	12	18	Screw
	5232941	-	-	1	CTR Rear Duct, Removable	6	5233883	1	-	-	Front Duct
							5232907	-	2	3	Front Duct
3	5232909	2	2	3	Rear Z-Bar	7	9024814	6	10	15	Screw
	5183536	4	4	6	Screw	8	9024814	4	6	8	Screw
	5234072	1	-	-	Plexiglas Support (NVF)	9	5231062	1	1	2	Plug Button



STRUCTURAL COMPONENTS - (CONT'D)
 DUCTS AND Z-BARS - NVD

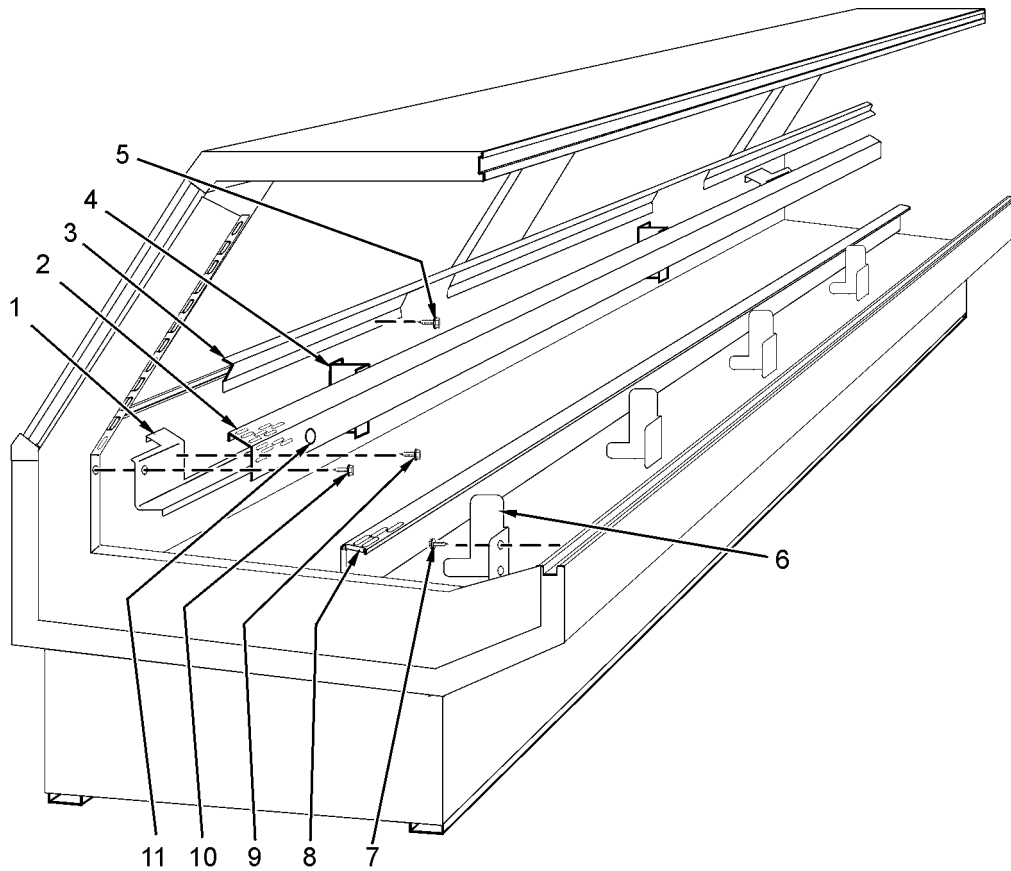

6', 8' and 12' Merchandiser

Item	Part No.	Quantity			Description	Item	Part No.	Quantity			Description
		6'	8'	12'				6'	8'	12'	
1	5240138	1	-	-	Rear Duct, Stationary	4	5232909	2	2	3	Rear Z-Bar
	5240139	-	1	-	Rear Duct, Stationary		5183536	4	4	6	Screw
	5240140	-	-	1	Rear Duct, Stationary	5	5205439	6	8	12	Screw
2	5233055	1	-	-	Rear Duct, Removable	6	5236956	4	6	9	Front Z-Bar
	5232997	-	1	1	RH RR Duct, Removable	7	5183536	8	12	18	Screw
	5232998	-	1	1	LH RR Duct, Removable	8	5233883	1	-	-	Front Duct
	5232941	-	-	1	CTR RR Duct, Removable		5232907	-	2	3	Front Duct
3	5236969	1	-	-	Air Deflector	9	9024814	6	10	15	Screw
	5236970	-	2	3	Air Deflector	10	9024814	4	6	8	Screw
						11	5231062	1	1	2	Plug Button



STRUCTURAL COMPONENTS - (CONT'D)
 PATCH ENDS, PARTITIONS AND DIVIDERS
 Solid Patch Ends - NVM/NVF/NVD

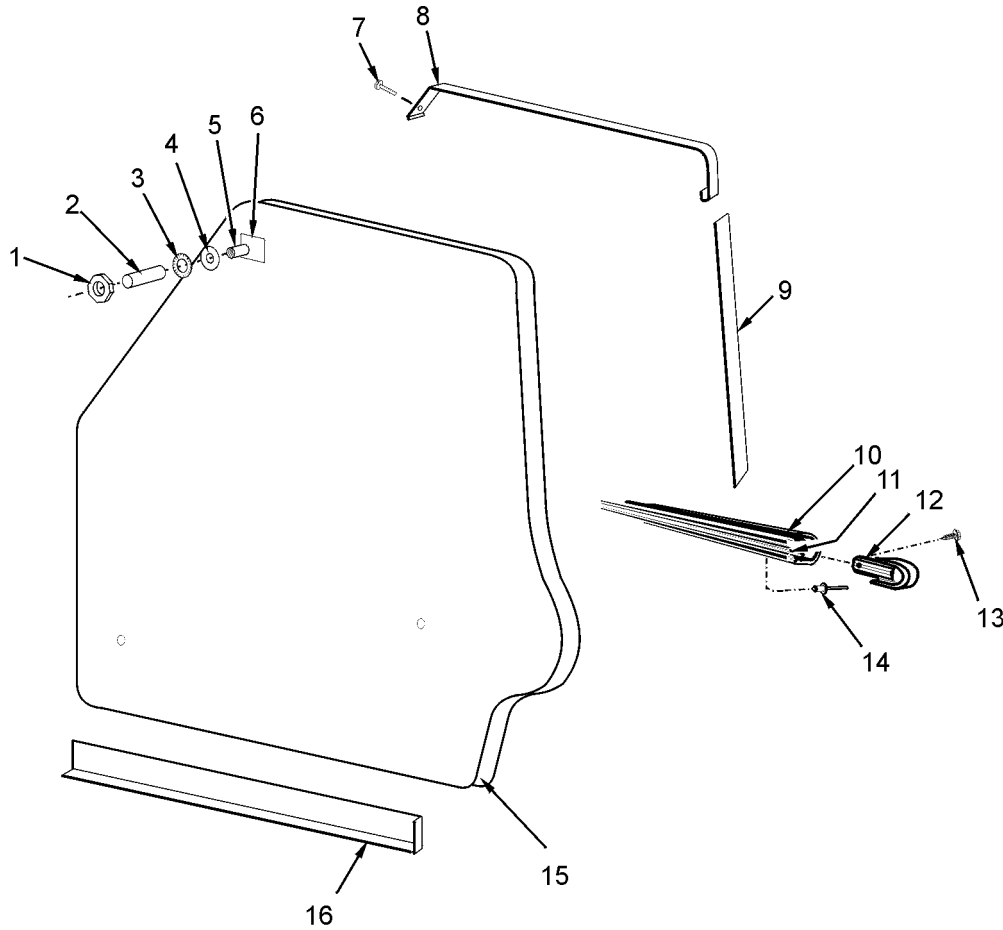

Item	Part No.	Qty.	Description	Item	Part No.	Qty.	Description
*	9021623	1	RH Solid End Assy. 52.875"		9023460	1	39" End Bumper, Cool Gray
*	9021624	1	LH Solid End Assy. 52.875"		9023461	1	39" End Bumper, Black
1	5100625	4	Nut, 5/16"-18		9023462	1	39" End Bumper, Pearl
2	9022759	1	Stud, 5/16"-18 x 3"		9310876	1	39" End Bumper, Steel Gray
	9030558	3	Stud, 5/16"-18 x 2"	11	9027882	1	35" End Bumper Retainer
3	5101003	4	Lockwasher		9023453	1	41" End Bumper Retainer
4	5100976	4	Washer	12	9026528	4	End Bmpr. Cap, Pearly Gates
5	9022756	4	Threaded Insert		9027743	4	End Bmpr. Cap, Cool Gray
6	9022760	4	Tapping Plate		9027744	4	End Bmpr. Cap, Black
7	5205439	1	Screw		9027742	4	End Bmpr. Cap, Pearl
8	9026512	1	Top End Trim, MB SS		9310881	4	End Bmpr. Cap, Steel Gray
9	9028857	1	RH Front End Trim, BLK	13	5183536	4	Screw
	9028858	1	LH Front End Trim, BLK	14	5104702	17	Rivet
10	9027973	1	33" End Bumper, Cool Gray	15	9024173	1	RH Bench Assy. 52.875"
	9027974	1	33" End Bumper, Black	*	9024174	1	LH Bench Assy. 52.875"
	9027975	1	33" End Bumper, Pearl	16	9022460	1	RH End Base Close-off, PTD
	9029311	1	33" End Bumper, Pearly Gates		9022467	1	LH End Base Close-off, PTD
	9040180	1	33" End Bumper, Steel Gray		1309067	3	Screw
	9023459	1	39" End Bumper, Pearly Gates				



STRUCTURAL COMPONENTS - (CONT'D)

PATCH ENDS, PARTITIONS AND DIVIDERS

Solid Patch Ends with Glass - NVM/NVF/NVD

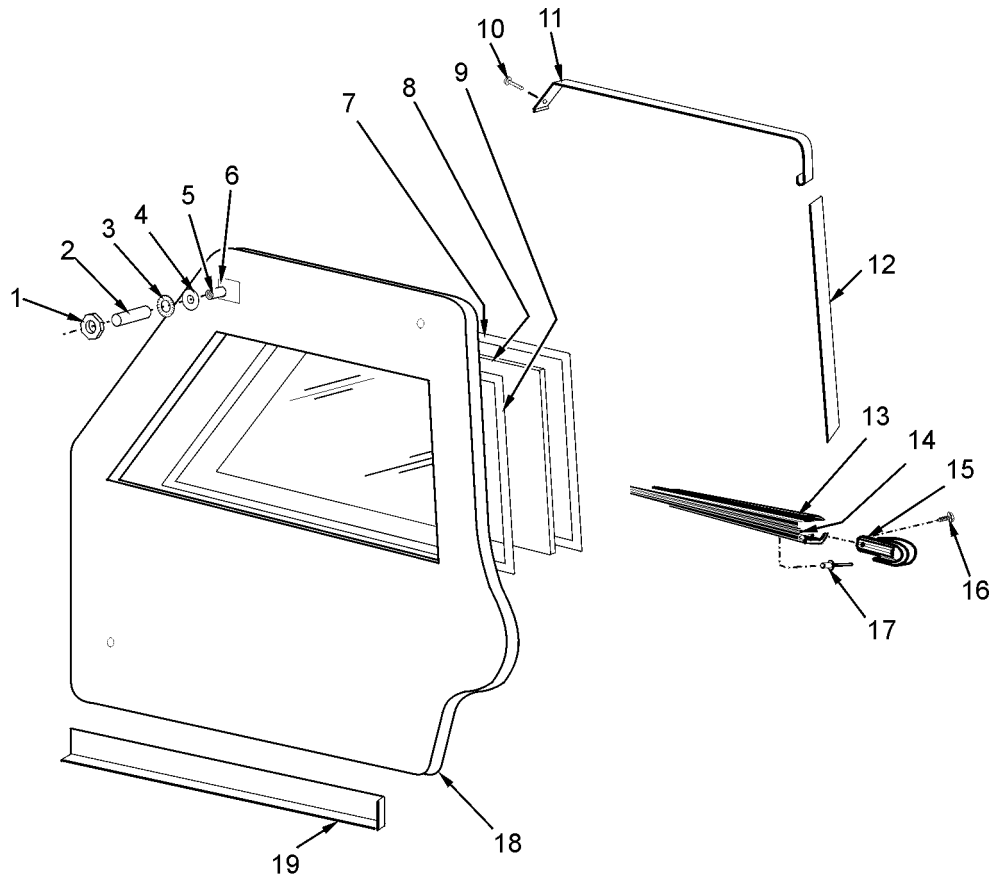

Item	Part No.	Qty.	Description	Item	Part No.	Qty.	Description
*	9021629	1	RH Solid End Assy. w/Glass 52.875"		9023459	1	39" End Bumper, Pearly Gates
*	9021630	1	LH Solid End Assy. w/Glass 52.875"		9023460	1	39" End Bumper, Cool Gray
1	5100625	4	Nut, 5/16"-18		9023461	1	39" End Bumper, Black
2	9022759	1	Stud, 5/16"-18 x 3"	14	9027882	1	39" End Bumper, Pearl
	9030558	3	Stud, 5/16"-18 x 2"		9023462	1	39" End Bumper, Steel Gray
3	5101003	4	Lockwasher	15	9026528	4	39" End Bumper, Pearl
4	5100976	4	Washer		9027743	4	39" End Bumper, Steel Gray
5	9022756	4	Threaded Insert		9027744	4	35" End Bumper Retainer
6	9022760	4	Tapping Plate		9027742	4	41" End Bumper Retainer
7	9024062	1	RH Glass Frame Assy.		9310881	4	End Bmpr. Cap, Pearly Gates
8	9024098	1	End Glass	16	5183536	4	End Bmpr. Cap, Cool Gray
9	9024099	1	LH Glass Frame Assy.	17	5104702	17	End Bmpr. Cap, Black
10	5205439	1	Screw	18	9024179	1	End Bmpr. Cap, Pearl
11	9026512	1	Top End Trim, MB SS		9024180	1	End Bmpr. Cap, Steel Gray
12	9028857	1	RH Front End Trim, BLK	19	9022460	1	End Bmpr. Cap, Steel Gray
	9028858	1	LH Front End Trim, BLK		9022467	1	Screw
13	9027973	1	33" End Bumper, Cool Gray		1309067	3	RH Base End Close-off, PTD
	9027974	1	33" End Bumper, Black				LH Base End Close-off, PTD
	9027975	1	33" End Bumper, Pearl				Screw
	9029311	1	33" End Bumper, Pearly Gates				
	9040180	1	33" End Bumper, Steel Gray				



STRUCTURAL COMPONENTS - (CONT'D)
PATCH ENDS, PARTITIONS AND DIVIDERS
1" Solid Partitions - NVM/NVF/NVD

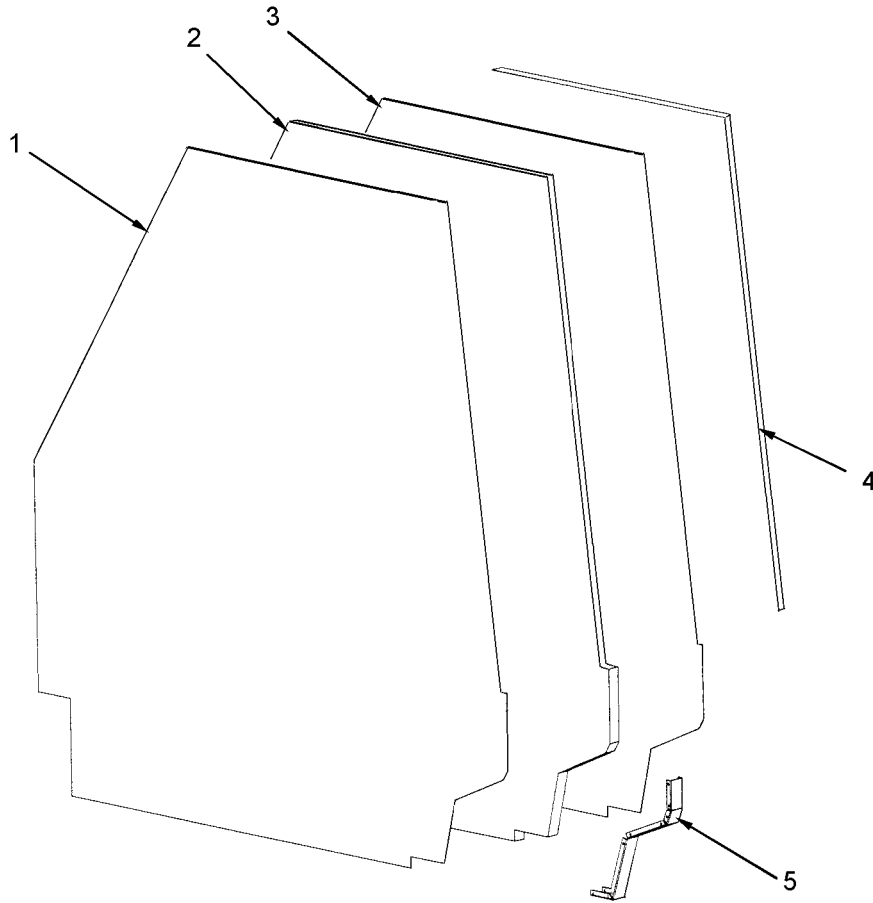

Item	Part No.	Qty.	Description
*	9022432	1	1" Solid Partition Assy.
1	9030204	1	LH Partition Panel
	5190307	5	Wood Spacer Block
2	5057165	2	Beadboard
3	9030203	1	RH Partition Panel
	5104702	14	Rivet
4	5239686	1	Front Retainer
5	9030205	1	Partition Trim



STRUCTURAL COMPONENTS - (CONT'D)
PATCH ENDS, PARTITIONS AND DIVIDERS
Floating Plexiglas Dividers - NVM/NVF/NVD

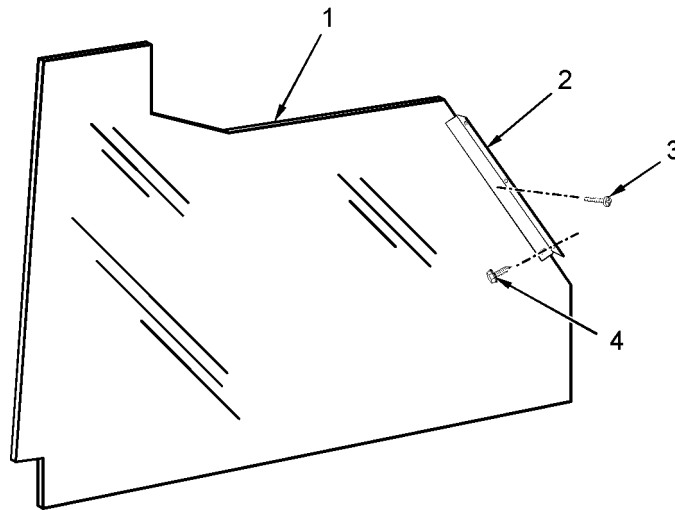

Item	Part No.	Qty.	Description
*	5999659	1	Plexiglas Partition Assy.
1	5999658	1	Floating Plexiglas Partition
2	5988201	1	Plexiglas Retainer
3	5111242	3	Spacer
	5100650	3	Nut
4	5183536	3	Screw



ELECTRICAL SYSTEM COMPONENTS
WIRING HARNESSSES - NVM/NVF
 Wiring and Components

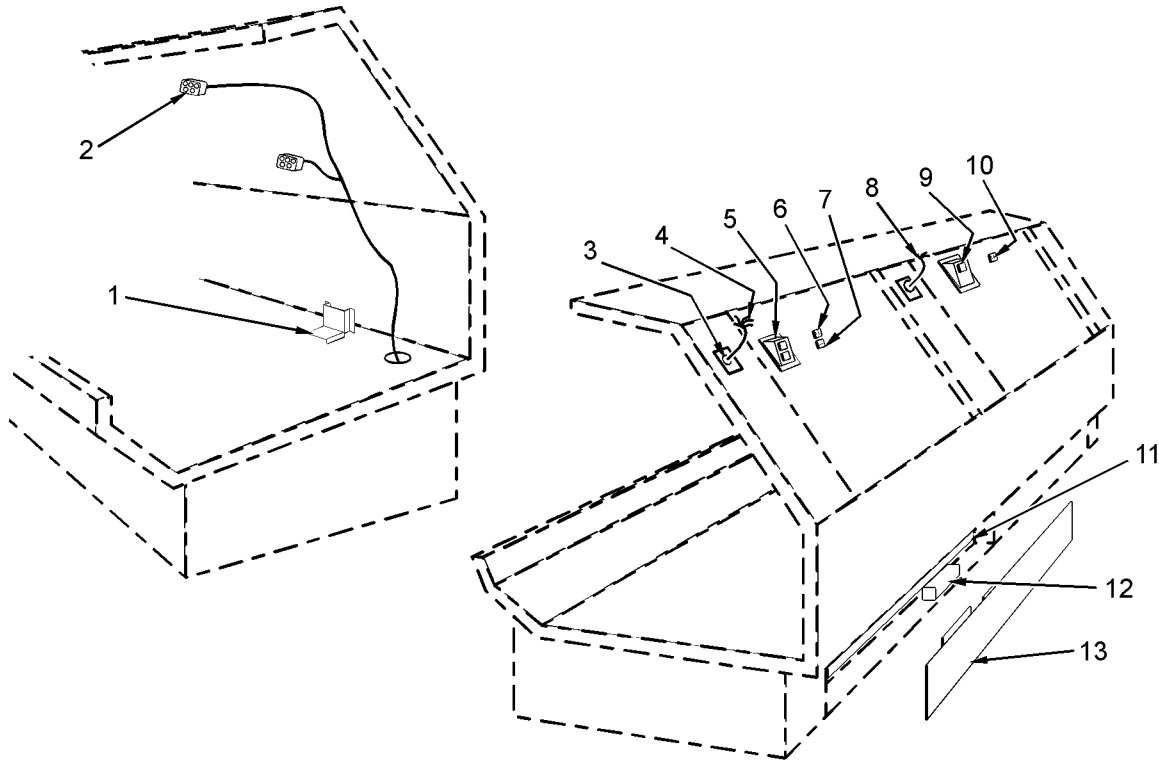

6', 8' and 12' Merchandiser

Item	Part No.	Quantity.			Description	Item	Part No.	Quantity.			Description
		6'	8'	12'				6'	8'	12'	
1	9024862	1	1	1	Lower Wiring Cover-NVM[F]	*	9043548	1	-	-	Electrical Rail MTG Assy.
	9024863	1	1	1	Lower Wiring Cover-NVD	*	9043549	-	1	1	Electrical Rail MTG Assy.
	5183536	2	2	2	Screw	11	9043546	1	-	-	Electrical Rail MTG
2	9025922	1	1	-	Horiz. Wiring Harness		9043547	-	1	1	Electrical Rail MTG
	9025923	-	-	1	Horiz. Wiring Harness		9036907	1	1	1	Power Lead MTG Bracket
	9025792	1	1	-	Top Light Harness		5183536	4	4	4	Screw
	9025793	-	-	1	Top Light Harness		5221557	1	1	1	Ballast Wiring-Blue
	5183536	2	2	2	Screw		5221558	1	1	1	Ballast Wiring-Red
3	5123674	1	4	4	Strain Relief	12	5991029	1	1	-	Ballast, 2-Lamp
4	5961380	1	1	1	Switch Harness		5991030	-	-	1	Ballast, 3-Lamp
5	5029007	1	1	1	Switch & Recept. Cover		5195131	3	3	3	Field Ground Lug
	5199134	2	2	2	Screw		5210988	1	1	1	Factory Ground Lug
6	5236335	1	1	1	Outlet		5933527	1	1	1	Terminal Block Assy.
7	5961377	1	1	1	Rocker Switch	13	9024929	1	-	2	Rear Rail Cover-6'
8	5961381	-	.1	1	Receptacle Harness		9024928	-	2	-	Rear Rail Cover-4'
9	5029006	-	1	1	Receptacle Cover		9043080	16	24	32	Screw
	5199134	-	2	2	Screw						
10	5236335	-	1	1	Outlet						



ELECTRICAL SYSTEM COMPONENTS - (CONT'D)
 FAN SYSTEMS - NVD

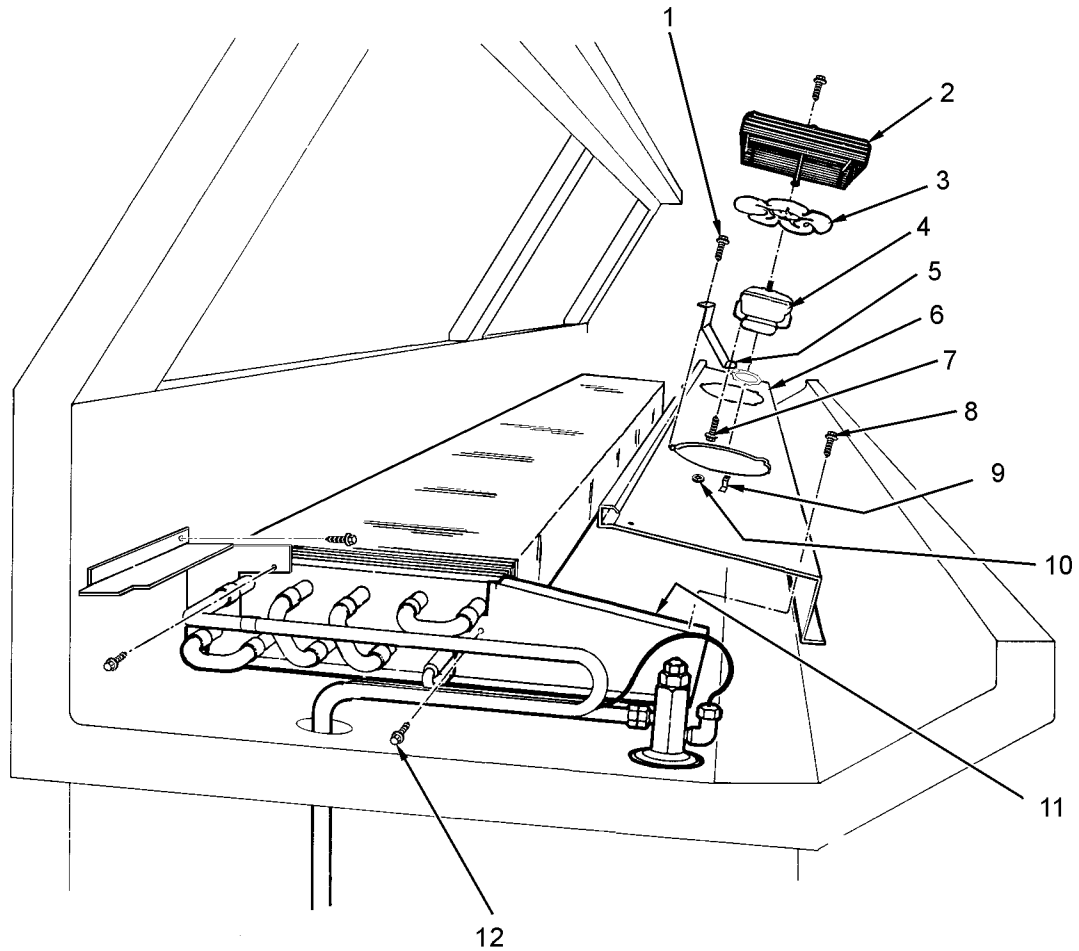

6', 8' and 12' Merchandiser

Item	Part No.	Quantity			Description	Item	Part No.	Quantity			Description
		6'	8'	12'				6'	8'	12'	
1	5224128	6	6	9	Screw	7	5224128	6	6	9	Screw
2	5063030	2	2	3	Fan Guard	8	5183536	10	10	15	Screw
*	5236973	2	2	3	Fan Motor Assy.-5W		5183536	11	15	15	Screw
	9030660	2	2	3	Opt. ECM Fan MTR Assy.-8W	9	5206177	2	2	3	Fan Clip
3	5236974	2	2	3	Fan Blade	10	5123674	3	3	3	Strain Relief
	5223370	2	2	3	Opt. ECM Fan Blade	11	9037117	1	1	1	LH Fan Panel Close-off
4	5125532	2	2	3	Fan Motor-5W		9037116	1	1	1	RH Fan Panel Close-off
	9025002	2	2	3	Opt. ECM Fan Motor-8 W	12	5183536	8	8	8	Screw
5	5962269	6	6	9	Fan Motor Bracket						
	9025005	6	6	9	Opt. ECM Fan Bracket						
6	9037137	1	-	-	Fan Panel						
	9037114	-	1	-	Fan Panel						
	9037115	-	-	1	Fan Panel						



ELECTRICAL SYSTEM COMPONENTS - (CONT'D)
TOP LIGHT - NVM/NVF

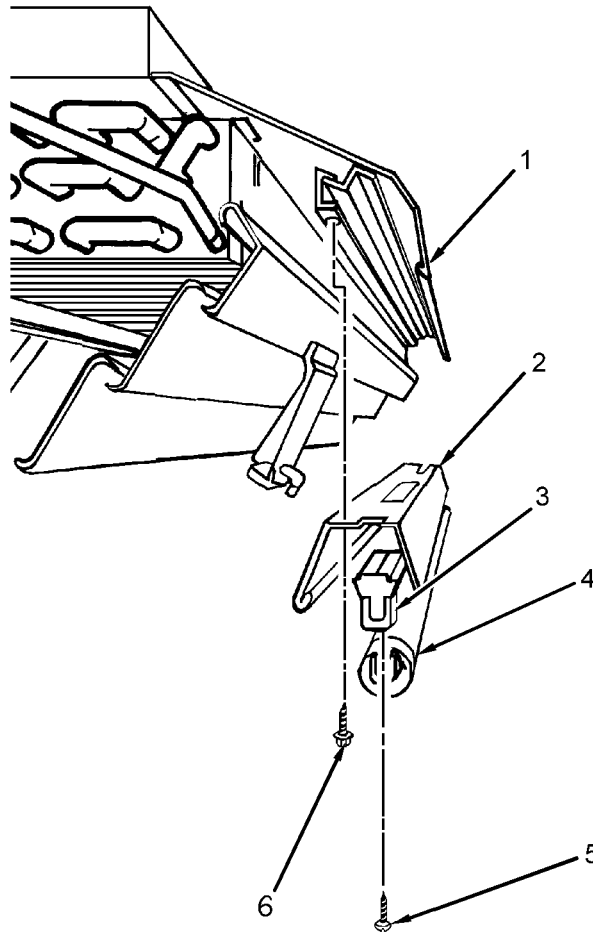

6', 8' and 12' Merchandiser

Item	Part No.	Quantity.			Description	Item	Part No.	Quantity.			Description
		6'	8'	12'				6'	8'	12'	
*	9025821	1	-	-	Light Channel Assy. NVM		5981332	-	1	-	Light Channel NVM
*	9025822	-	1	-	Light Channel Assy. NVM		5981333	-	-	1	Light Channel NVM
*	9025823	-	-	1	Light Channel Assy. NVM		5966395	1	-	-	Light Channel NVF
	5235061	1	-	-	Light Channel Support NVM		5993207	-	1	-	Light Channel NVF
	5235062	-	1	-	Light Channel Support NVM		5966396	-	-	1	Light Channel NVF
	5235063	-	-	1	Light Channel Support NVM	3	5232279	4	4	6	Lampholder
	5966393	1	-	-	Light Channel Support NVF	4	5987031	2	-	-	Shield & Cap Assy.
	5993206	-	1	-	Light Channel Support NVF		5981621	-	2	3	Shield & Cap Assy.
	5966394	-	-	1	Light Channel Support NVF		-----	2	2	3	Lamp
	5626798	11	11	13	Rivet S/S	5	5214107	4	4	6	Screw
	5246013	1	1	1	LH Close-off	6	9023806	5	6	9	Screw
	5246012	1	1	1	RH Close-off						
1	5244319	1	-	-	Light Shield Assy.						
	5244320	-	1	-	Light Shield Assy.						
	5244321	-	-	1	Light Shield Assy.						
2	5232283	1	-	-	Light Channel NVM						



ELECTRICAL SYSTEM COMPONENTS - (CONT'D)
TOP LIGHT - NVD

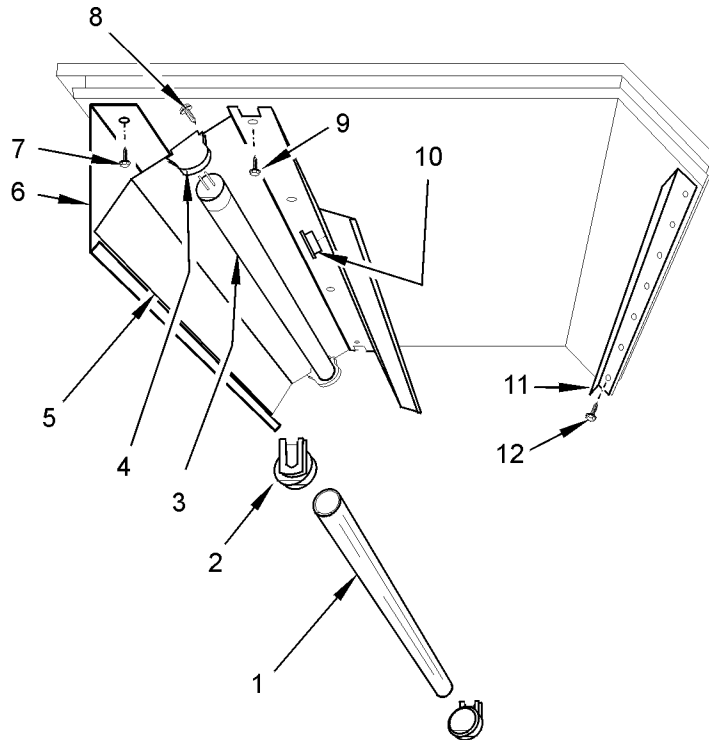

6', 8' and 12' Merchandiser

Item	Part No.	Quantity.			Description	Item	Part No.	Quantity.			Description
		6'	8'	12'				6'	8'	12'	
*	5987031	2	-	-	Lampshield & Caps Assy.	8	5208265	1	1	1	Screw
*	5981621	-	2	3	Lampshield & Caps Assy.		5103997	2	2	2	Washer-SHKPRF
1	5987030	2	-	-	Lampshield - 36"		5100661	1	1	1	Nut
	5981622	-	2	3	Lampshield - 46"	9	5183536	3	3	4	Screw
2	5981627	4	4	6	Caps	10	5124331	1	1	1	Bushing
3	Ref	2	2	3	Lamp - F32 T-8/TI	11	5236203	-	2	2	Raceway Support
4	5232279	4	4	6	Lampholder	12	5183536	-	3	5	Screw
5	5966395	1	-	-	Light Channel						
	5993207	-	1	-	Light Channel						
	5966396	-	-	1	Light Channel						
6	5966393	1	-	-	Light Shield						
	5993206	-	1	-	Light Shield						
	5966394	-	-	1	Light Shield						
7	5183536	4	4	6	Screw						



REFRIGERATION SYSTEM COMPONENTS
TOP AND BOTTOM COIL ASSEMBLIES - NVM

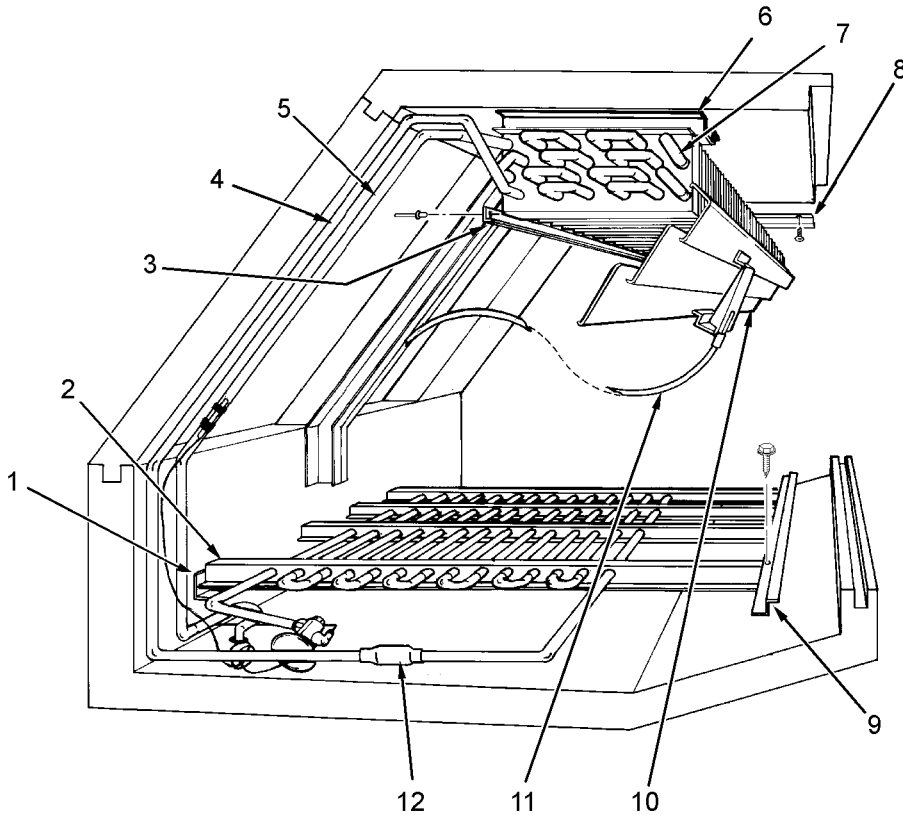

6', 8' and 12' Merchandiser

Item	Part No.	Quantity			Description	Item	Part No.	Quantity			Description
		6'	8'	12'				6'	8'	12'	
1	5234000	3	4	6	Rear Coil Support	6	5183536	3	4	6	Screw
2	5219744	1	-	-	Bottom Coil Assy.	10	5240070	1	-	-	Baffle Assy.
	5961139	-	1	-	Bottom Coil Assy.		5240060	-	1	-	Baffle Assy.
	5961140	-	-	1	Bottom Coil Assy.		5240061	-	-	1	Baffle Assy.
3	5234809	1	-	-	Baffle Support		5240062	1	-	-	Front Baffle
	5234810	-	1	-	Baffle Support		5240064	-	1	-	Front Baffle
	5234811	-	-	1	Baffle Support		5240066	-	-	1	Front Baffle
	5104702	3	4	4	Rivet		5240063	1	-	-	Rear Baffle
4	5966594	1	1	1	Liquid Line		5240065	-	1	-	Center & Rear Baffle
5	5966595	1	1	1	Suction Line		5240067	-	-	1	Center & Rear Baffle
6	5243764	3	4	4	Top Coil Support		5961322	2	2	2	Support
	5205213	18	24	24	Screw		5961104	9	12	12	Clip
	5235030	3	4	4	Coil Hanger		5237490	29	38	38	Rivet
	5244427	2	2	2	Coil Centering Clip	*	5997164	1	1	1	Drain Pod & Clip Assy.
	5208265	2	2	2	Screw		5237490	2	2	2	Rivet
7	5244431	1	-	-	Top Coil Assy.		5961855	1	1	1	Drain Pod
	5244432	-	1	-	Top Coil Assy.		5996738	1	1	1	Clip
	5244433	-	-	1	Top Coil Assy.	11	5236590	32"	32"	32"	Drain Hose
8	5961383	1	1	1	Harness Cover	12	5234939	1	1	1	Heat Exchanger Assy.
	1309067	3	3	3	Screw		5234938	1	1	1	Inlet Tube Assy.
9	5233980	1	-	-	Front Coil Support		5235049	1	1	1	Heat Exchanger Tube
	5233981	-	1	-	Front Coil Support		5235050	1	1	1	Equalizer Assy.
	5233982	-	-	1	Front Coil Support						



REFRIGERATION SYSTEM COMPONENTS - (CONT'D)
TOP COIL ASSEMBLIES - NVF

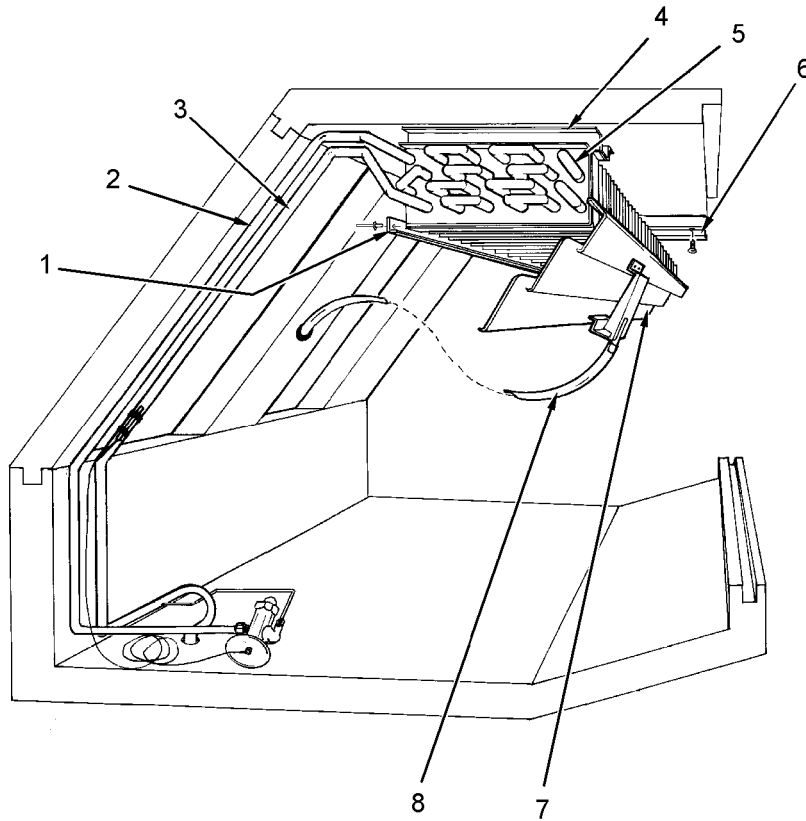

6', 8' and 12' Merchandiser

Item	Part No.	Quantity			Description	Item	Part No.	Quantity			Description
		6'	8'	12'				6'	8'	12'	
1	5234809	1	-	-	Baffle Support	7	5240070	1	-	-	Baffle Assy.
	5234810	-	1	-	Baffle Support		5240060	-	1	-	Baffle Assy.
	5234811	-	-	1	Baffle Support		5240061	-	-	1	Baffle Assy.
	5104702	3	4	4	Rivet		5240062	1	-	-	Front Baffle
2	5966597	1	1	1	Liquid Line Assy.	5240064	-	1	-	Front Baffle	
3	5966599	1	1	1	Suction Line Assy.	5240066	-	-	1	Front Baffle	
4	5243764	3	4	4	Coil Support Channel	5240063	1	-	-	Rear Baffle	
	5641102	3	4	4	Hanger	5240065	-	1	-	Center & Rear Baffle	
	5205213	18	24	24	Screw	5240067	-	-	1	Center & Rear Baffle	
	5244427	2	2	2	Coil Centering Clip	5961322	2	2	2	Support	
	5205213	2	2	2	Screw	5961104	9	12	12	Clip	
5	5244428	1	-	-	Coil Assy.	5237490	29	38	38	Rivet	
	5244429	-	1	-	Coil Assy.	* 5997164	1	1	1	Drain Pod & Clip Assy.	
	5244430	-	-	1	Coil Assy.	5237490	2	2	2	Rivet	
6	5961383	1	1	1	Harness Cover	5961855	1	1	1	Drain Pod	
	1309067	3	3	3	Screw	5996738	1	1	1	Clip	
8	5236590	32"	32"	32"	Drain Hose						



REFRIGERATION SYSTEM COMPONENTS - (CONT'D)
 BOTTOM COIL ASSEMBLIES - NVD

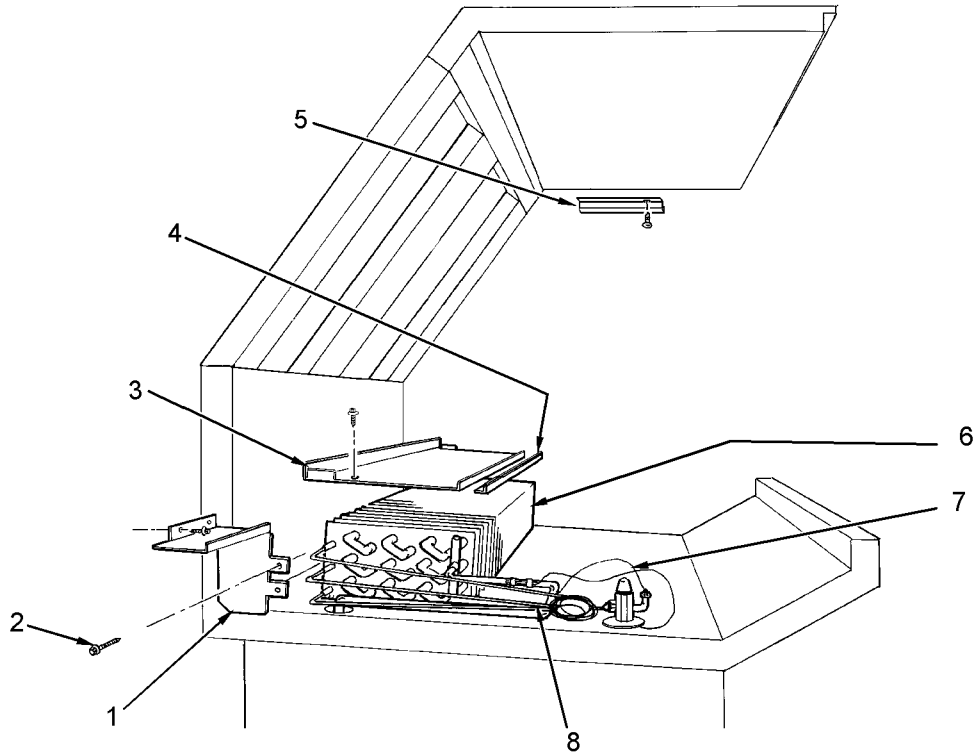

6', 8' and 12' Merchandiser

Item	Part No.	Quantity			Description
		6'	8'	12'	
1	5240512	1	1	1	LH Coil End Close-off
	5240513	1	1	1	RH Coil End Close-off
2	5183536	4	4	4	Screw
	5236313	1	-	-	Coil Cover
	5236314	-	1	-	Coil Cover
	5236315	-	-	1	Coil Cover
3	5183536	4	4	6	Screw
	5236316	1	-	-	Coil Cover Front Filler
	5236317	-	1	-	Coil Cover Front Filler
	5236318	-	-	1	Coil Cover Front Filler
4	5961383	1	1	1	Harness Cover
	1309067	3	3	3	Screw
5	5234431	1	-	-	Coil Fitting Assy.
	5234432	1	-	1	Coil Fitting Assy.
	5234433	-	-	1	Coil Fitting Assy.
6	5234326	1	1	1	Liquid Line Assy.
7	5246392	1	1	1	Suction Line Assy.



OPTIONAL CASE ACCESSORIES
SHELF ASSEMBLIES - NVM/NVF/NVD
Optional 10" & 12" Mezzanine Shelves w/o Lights

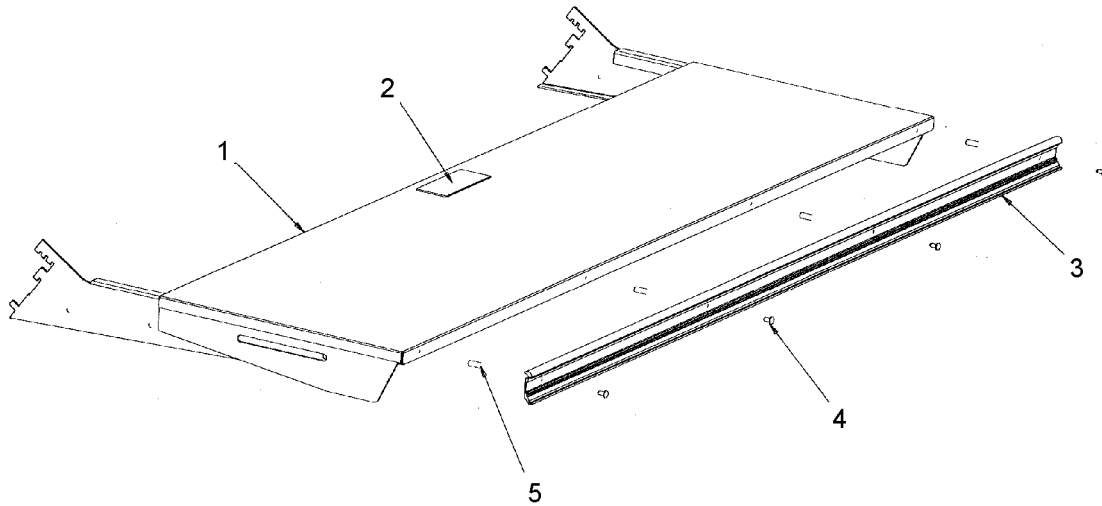

Item	Part No.	Qty.	Description
*	9603952	1	Mezz. Shelf Assy., 10" x 48" MB/SS w/o Lights
*	9603953	1	Mezz. Shelf Assy., 12" x 48" MB/SS w/o Lights
1	5234347	1	Shelf-10"X48", MB/SS
	5234352	1	Shelf-12"X48", MB/SS
2	5239718	1	Cleaning Label
3	5236879	1	Card Moulding-48"
4	9024814	4	Screw
5	9043078	4	Round Cap



OPTIONAL CASE ACCESSORIES - (CONT'D)
 SHELF ASSEMBLIES - NVM/NVF/NVD
 Optional 10" & 12" Mezzanine Shelves w/ T-8 Lights

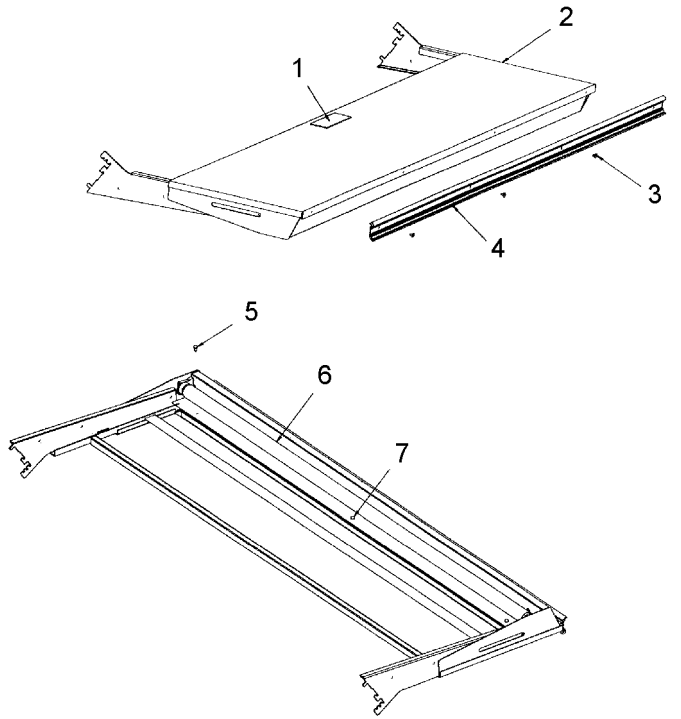

Item	Part No.	Qty.	Description	Item	Part No.	Qty.	Description
*	9603926	1	Mezz. Lighted Shelf Assy., 10" x 48" MB/SS	4	5236879	1	Card Moulding
*	9603913	1	Mezz. Lighted Shelf Assy., 12" x 48" MB/SS	5	9024814	3	Screw
1	5239718	1	Cleaning Instruction Label	6	9027657	1	Light Channel Assy. - T-8
2	5234347	1	Shelf-10" X 48"	5234343	1	Light Channel-8' & 12' Models	
	5234352	1	Shelf-12" X 48"	5981627	2	Lampholders-T8	
3	9029415	4	Screw	5238845	1	Clamp	
				5103996	2	Lock Washer	
				5111197	2	Screw	
				5111198	2	Nut	
				5214107	2	Screw	
				5981622	1	Lamp Shield	
				9027906	1	Shelf Feed Harness	
				7	9024814	3	Screw



OPTIONAL CASE ACCESSORIES - (CONT'D) SHELF ASSEMBLIES - NVM/NVD/NVF

Optional 30", 48" & 60" Wrap Shelves

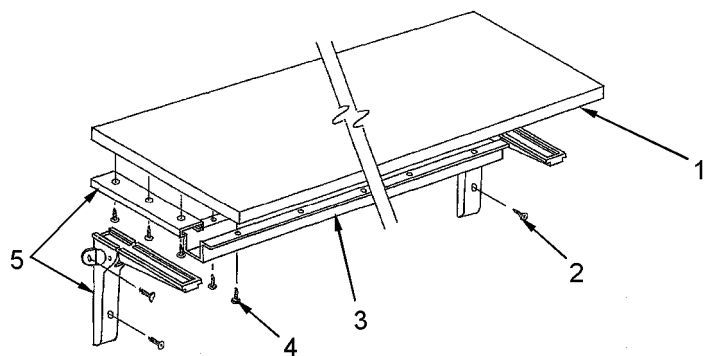

Item	Part No.	Qty.	Description
*	5952011	1	30" Poly Wrap Shelf Assy.
1	5951959	1	Poly Board, 9.5" x 29"
2	1309067	6	Screw
3	5952010	1	Reinforcement Channel
4	5100212	12	Screw
5	5182581	2	Bracket
*	5190217	1	48" Poly Wrap Shelf Assy.
1	5190222	1	Poly Board, 9.5" x 47"
2	1309067	3	Screw
3	5190220	1	Reinforcement Channel
4	5123781	14	Screw
5	5182581	2	Bracket
*	5986525	1	48" Poly Wrap Shelf Assy.
1	5986523	1	Poly Board, 7.25" x 47"

2	1309067	6	Screw
3	5190220	1	Reinforcement Channel
4	5123781	14	Screw
5	5182581	2	Bracket
*	5182582	1	48" Wood Wrap Shelf Assy.
1	5183579	1	Wood Shelf, 48"
2	1309067	3	Screw
3	-----	-	N/A
4	-----	-	N/A
5	5182581	2	Bracket
*	5190218	1	60" Poly Wrap Shelf Assy.
1	5190221	1	Poly Board, 9.5" x 47"
2	1309067	9	Screw
3	-----	-	N/A
4	5123781	9	Screw
5	5182581	3	Bracket
*	9603495	1	48" BLK Poly Wrap Shelf Assy.
1	9603493	1	BLK Poly Board, 9.50" x 47"
2	1309067	6	Screw
3	5190220	1	Reinforcement Channel
4	5183536	14	Screw
5	5182581	2	Bracket
*	5182583	1	60" Wood Wrap Shelf Assy.
1	5182580	1	Wood Shelf, 60"
2	1309067	9	Screw
3	-----	-	N/A
4	-----	-	N/A
5	5182581	3	Bracket

Optional Top Mount Scale Shelves

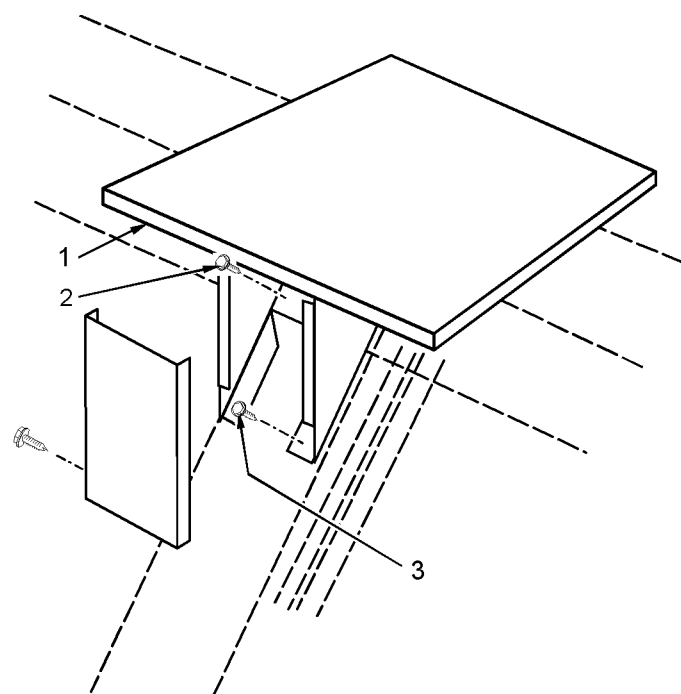

Item	Part No.	Qty.	Description
*	5233325	1	Top Mount Scale Shelf Assy., 14" x 16" (BRT/SS)
*	5233327	1	Top Mount Scale Shelf Assy., 14" x 22" (BRT/SS)
*	5985212	1	Top Mount Scale Shelf Assy., 20" x 22" (BRT/SS)
*	5985078	1	Top Mount Scale Shelf Assy., 14" x 16" (wood)
*	5986639	1	Top Mount Scale Shelf Assy., 14" x 16" (poly)
1	5233326	1	SS Scale Shelf Bench Assy., 14" x 16"
	5233328	1	SS Scale Shelf Bench Assy., 14" x 22"
	5985211	1	SS Scale Shelf Bench Assy., 20" x 22"
	5985077	1	Wd. Scale Shelf Bench Assy., 14" x 16"
	5986640	1	Poly Scale Shelf Bench Assy., 14" x 16"
2	1309067	2	Screw
3	5205439	2	Screw



OPTIONAL CASE ACCESSORIES - (CONT'D)
 SHELF ASSEMBLIES - NVM/NVD/NVF
 Optional Rear Mount Scale Shelves

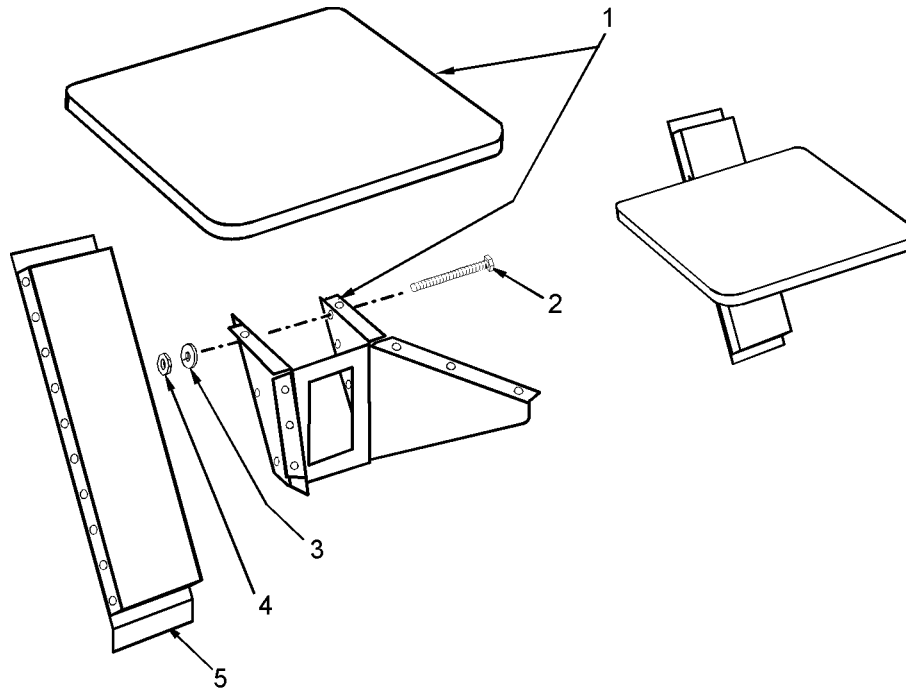

Item	Part No.	Qty.	Description	Item	Part No.	Qty.	Description
*	5995784	1	Rear Mount Scale Shelf Assy., 14" x 16" (Poly)	9030934	1	Poly Scale Shelf Assy., 16"x18"	
*	5995952	1	Rear Mount Scale Shelf Assy., 14" x 16" (Poly)	9030393	1	Shelf	
*	5988940	1	Rear Mount Scale Shelf Assy., 16" x 16" (Poly)	5991023	1	Poly Scale Shelf Assy., 16"x22"	
*	9030395	1	Rear Mount Scale Shelf Assy., 16" x 18" (Poly)	5991024	1	Shelf	
*	5991022	1	Rear Mount Scale Shelf Assy., 16" x 22" (Poly)	5233284	1	Poly Scale Shelf Assy., 20"x22"	
*	5233297	1	Rear Mount Scale Shelf Assy., 20" x 22" (Poly)	5946608	1	Shelf	
*	5233296	1	Rear Mount Scale Shelf Assy., 20" x 22" (Wood)	5233283	1	Wood Scale Shelf Assy., 20"x22"	
*	5990298	1	Rear Mount Scale Shelf Assy., 20" x 22" (BRT/SS)	5991076	1	Shelf	
1	5995783	1	Poly Scale Shelf Assy., 14"x16"	5990297	1	BRT/SS Scale Shelf Assy., 20"x22"	
	5223757	1	Shelf	5953081	1	Shelf	
	5995951	1	Poly Scale Shelf Assy., 14"x16"	5988938	1	Bracket (for 16" & 18" shelves)	
	5995948	1	Shelf	5233211	1	Bracket (for 22" shelves)	
	5988939	1	Poly Scale Shelf Assy., 16"x16"	5619204	8	Screw	
	5988936	1	Shelf	2	5220088	3	Screw
				3	5101000	3	Lockwasher
				4	5100616	3	Nut
				5	5994298	1	Upright Support
					1309067	4	Screw
					5183536	2	Screw
					5100918	1	Plug Button



OPTIONAL CASE ACCESSORIES - (CONT'D)
 SHELF ASSEMBLIES - NVM/NVD/NVF
 Optional Front Bread Shelves

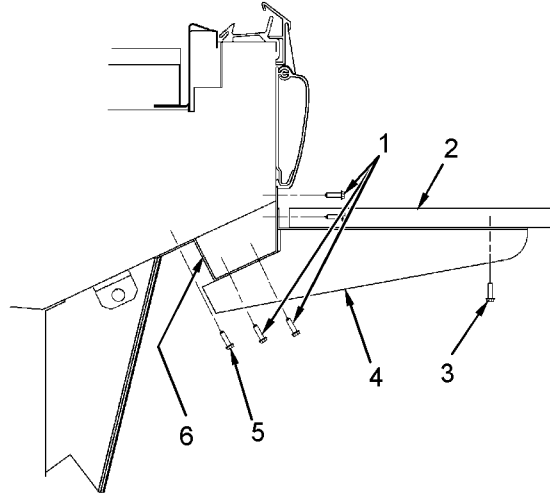

6', 8' and 12' Merchandiser

Item	Part No.	Quantity			Description	Item	Part No.	Quantity			Description
		6'	8'	12'				6'	8'	12'	
*	9020798	1	-	-	Front Shelf Mounting		5949995	-	-	1	12' Shelf, Imp. Oak
*	9020255	-	1	-	Front Shelf Mounting		5980463	-	-	1	12 Shelf, Black
*	9020256	-	-	1	Front Shelf Mounting		5615266	-	-	1	12' Shelf, Walnut
1	1309067	6	8	12	Screw		5951903	-	-	1	12 Shelf, White
2	5949993	1	-	-	6' Shelf, Imp. Oak		5985687	-	-	1	12' Shelf, Red
	5980461	1	-	-	6' Shelf, Black	3	5205439	9	12	18	Screw
	5949994	-	1	-	8' Shelf, Imp. Oak	4	9022870	3	4	6	Front Shelf Bracket
	5980462	-	1	-	8' Shelf, Black	5	5183536	8	7	11	Screw
	5615265	-	1	-	8' Shelf, Walnut	6	9022871	1	-	-	6' Shelf Support
	5951902	-	1	-	8' Shelf, White		9022872	-	1	-	8' Shelf Support
	5985686	-	1	-	8' Shelf, Red		9022873	-	-	1	12' Shelf Support



**OPTIONAL CASE ACCESSORIES - (CONT'D)
SCREENS, FENCES AND TRAYS**

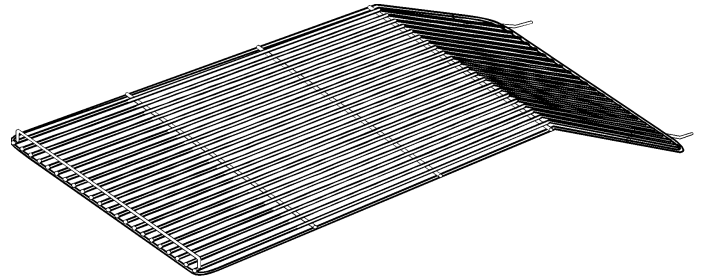
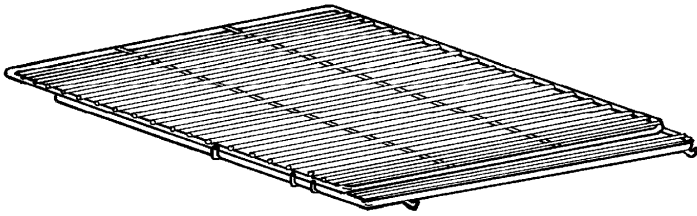

Optional Telescoping Screens

Item	Part No.	Quantity			Description
		6'	8'	12'	
-	5946888	3	4	6	Telescoping Screen, WPC (NVM/NVD)
-	5199443	3	4	6	Telescoping Screen, WPC (NVF)
-	5997065	3	4	6	Telescoping Screen, BPC (NVF)

Optional 4" Angled Screens (NFM)

Item	Part No.	Qty.	Description
-	5987530	1	4" Angled Screen, WPC
-	9031153	1	4" Angled Screen, BPC

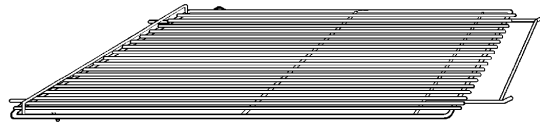

Optional Flat Elevating Screen

Item	Part No.	Quantity			Description
		6'	8'	12'	
-	5987201	3	4	6	Flat Elevating Screen, 23 5/8" x 32 1/4"
-	5962128	3	4	6	Flat Elevating Screen, 23 5/8" x 29 1/16"

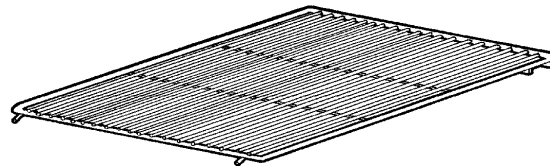

Optional Flat Screen

Item	Part No.	Quantity			Description
		6'	8'	12'	
-	5233835	3	4	6	Flat Screen, 23 5/8" x 33 1/2"



OPTIONAL CASE ACCESSORIES - (CONT'D)
SCREENS, FENCES AND TRAYS

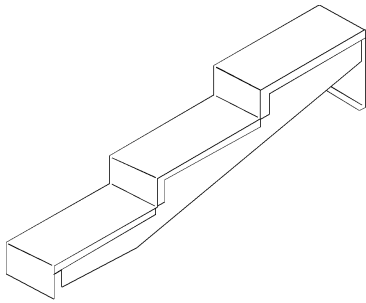

Optional 3-Step Narrow Solid Tray

Item	Part No.	Qty.	Description
-	5233573	1	3-Step Narrow Tray (NVM/NVD - 8' & 12')

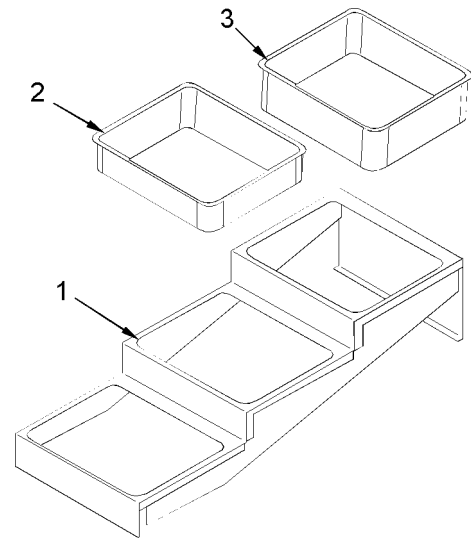

Optional 3-Step Trays w/ Openings & Pans

Item	Part No.	Qty.	Description
*	5233607	1	3-Step Tray Assy. w/Openings & Pans (all 8' & 12' cases)
1	5233608	1	3-Step Tray w/Openings
2	5146721	1	4 1/2 Qt. Pan
3	5106467	2	6 1/2 Qt. Pan

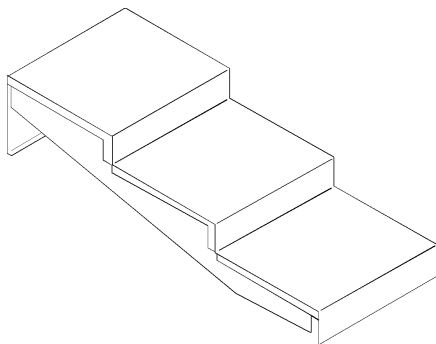

Optional 3-Step Solid Trays

Item	Part No.	Qty.	Description
-	5233536	1	3-Step Solid Tray (all 8' & 12' cases)
-	5233574	1	3-Step Solid Tray (all 8' & 12' cases)

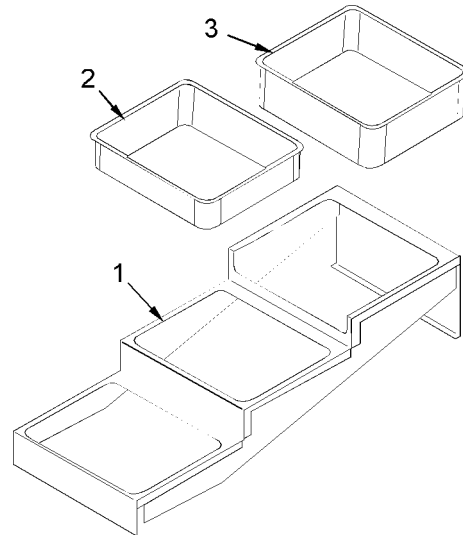

Optional 3-Step Tray w/ Cutouts & Pans

Item	Part No.	Qty.	Description
*	5233595	1	3-Step Tray Assy.w/Cutouts & Pans (NVM/NVD - 8' & 12')
1	5233594	1	3-Step Tray w/Openings
2	5146721	1	4 1/2 Qt. Pan
3	5106467	2	6 1/2 Qt. Pan



OPTIONAL CASE ACCESSORIES - (CONT'D) SCREENS, FENCES AND TRAYS

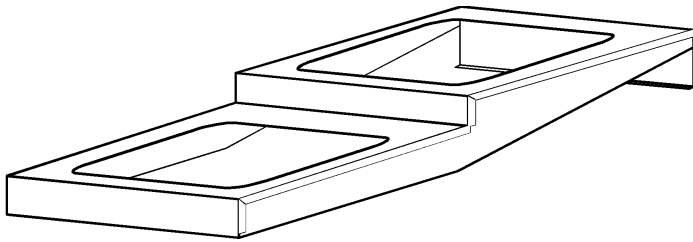

Optional 2-Step Trays w/ Cutouts

Item	Part No.	Qty.	Description
-	5932087	1	2-Step Tray w/Cutouts (NVM/NVF/NVD - 6', 8' & 12')
-	5999429	1	2-Step Tray w/Cutouts (NVM/NVF/NVD - 8' & 12')

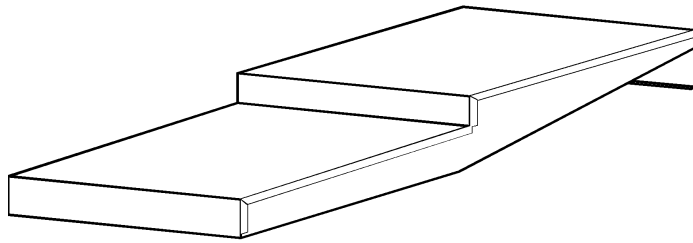

Optional 2-Step Solid Trays

Item	Part No.	Qty.	Description
-	5932088	1	2-Step Solid Tray (2 1/2" drop) (NVM/NVF/NVD - 6', 8' & 12')
-	5987813	1	2-Step Solid Tray (NVM/NVF/NVD - 8' & 12')
-	5987815	1	2-Step Solid Tray (3 3/4" drop) (NVD - 8' & 12')

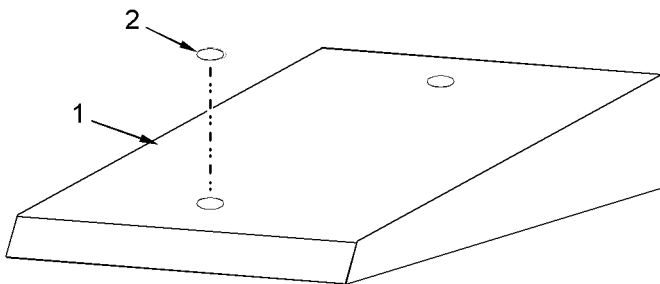

Optional Elevated Tray

Item	Part No.	Qty.	Description
-	5996969	1	3" - 10" Elevated Tray
1	5996985	1	Elevated Tray
2	5124331	2	Bushing

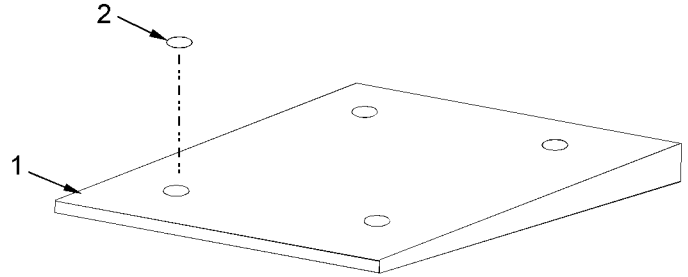

Optional Elevated Tray

Item	Part No.	Qty.	Description
-	5986294	1	1 1/2" - 4" Elevated Tray
1	5986292	1	Elevated Tray
2	5124331	4	Bushing

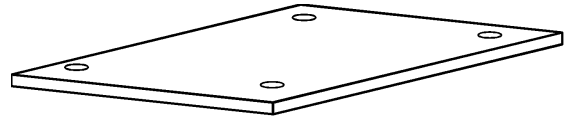

Optional Ice Trays

Item	Part No.	Quantity			Description
		6'	8'	12'	
-	5233649	-	4	6	Reinforced Ice Tray, NVF
-	5233662	3	4	6	Ice Tray, NVF
-	5995130	-	4	6	Ribbed Ice Tray, NVF
-	5996407	3	4	6	Ice Tray (NVD - 6') (NVM - 6', 8' & 12') (NVF - 8' & 12')

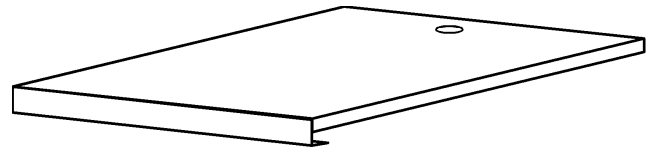

Bottom Trays

Item	Part No.	Quantity			Description
		6'	8'	12'	
-	5233654	3	4	6	Bottom Tray, BRT/SS (NVD) - Std
-	5235742	-	4	6	Bottom Tray, MB/SS (NVM) - Std



OPTIONAL CASE ACCESSORIES - (CONT'D) THERMOMETERS

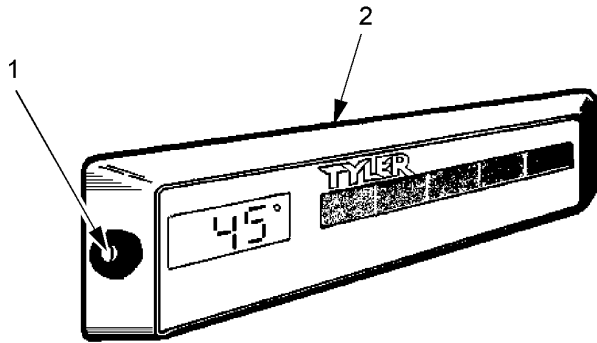

Digital Solar Thermometer

Item	Part No.	Qty.	Description
*	5230912	1	Digital Thermometer Assy., F°
*	5988308	1	Digital Thermometer Assy., C°
1	5230884	2	Screw
2	5239500	1	Digital Thermometer, F°
	5239501	1	Digital Thermometer, C°
-	5100902	1	Clamp, Plastic
-	5111198	1	Nut
-	5127438	2	Rear Deflector Spacer
-	5185153	1	Screw
-	5218751	3	Clip Cord

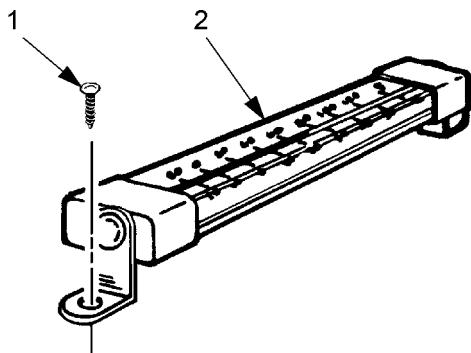

Standard Thermometer

Item	Part No.	Qty.	Description
*	5967100	1	Thermometer

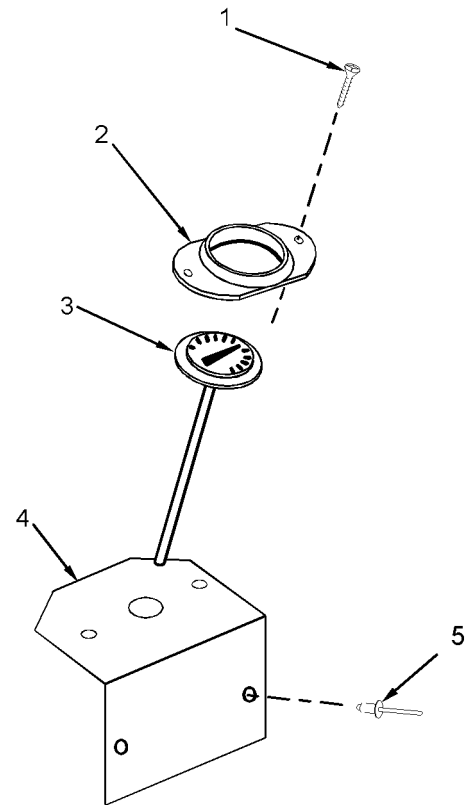

1" Dial Thermometer, Rear Duct

Item	Part No.	Qty.	Description
*	5985278	1	1" Dial Thermometer Assy.
1	5219883	2	Screw
2	----	1	Mounting Ring (furn. w/therm.)
3	5203829	1	1" Dial Thermometer
4	5235142	1	Thermometer Support
5	5104702	2	Rivet

1" Dial Thermometer, Top Coil

Item	Part No.	Qty.	Description
*	9024966	1	1" Thermometer Assy., Top Coil
1	9024814	2	Screw
2	----	1	Mounting Ring (furn. w/therm.)
3	5203829	1	1" Dial Thermometer
-	9024967	1	Bracket (not shown)
	9043078	2	Round Cap - Blue



OPTIONAL CASE ACCESSORIES - (CONT'D) THERMOMETERS

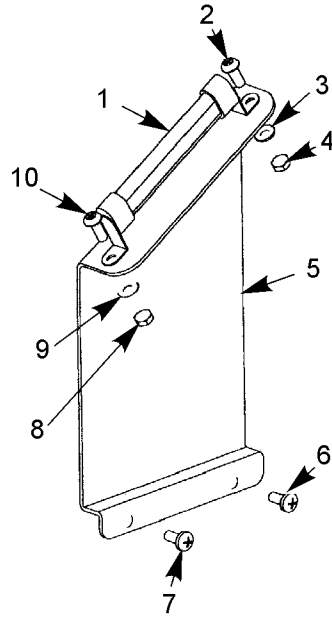

Standard Thermometer & Mounting

Item	Part No.	Qty.	Description
*	9043556	1	Thermometer Assembly
1	5967100	1	Pencil Thermometer
2	5208265	1	Screw
3	5100387	1	Lock Washer
4	5100661	1	Nut
5	9043550	1	Bracket
6	9024883	1	Screw
7	9024883	1	Screw
8	5100661	1	Nut
9	5100387	1	Flat Washer
10	5208265	1	Screw